

Garrett Hwy
Oakland, MD 21550

BUILD TO SUIT

LEASE COST TO BE DETERMINED
BASED ON TENANT SPECS

Aerial - Site View

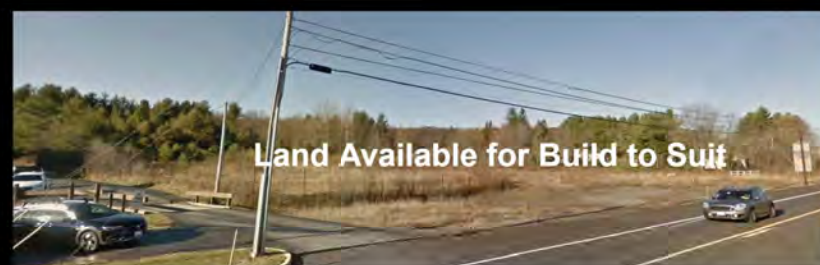

Land Available for Build to Suit

Approximately 3.82 acres available for development
across from Wal-Mart

Price based upon tenant needs

Located on State Route 219 a major hub rapidly
developing in the area

Population Density Shading

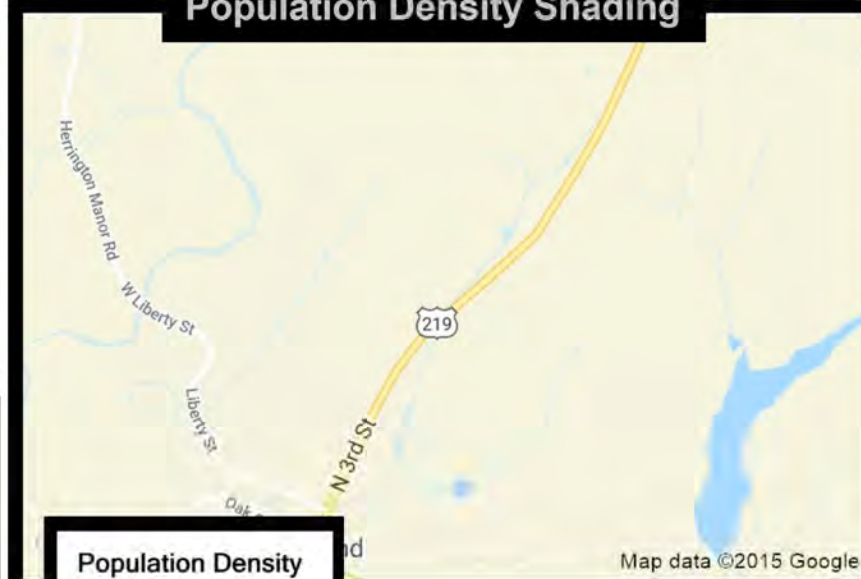

Population Density

By Blockgroups



Demographic Data

	3 mi radius	5 mi radius	10 mi radius
Population (2019)	6,084	9,750	20,185
Households (2019)	2,822	4,410	9,006
Median household income (2019)	\$46,194	\$48,961	\$49,393
Total Employees	7,094	7,651	11,926
Total Establishments	650	738	1,190

COCCA DEVELOPMENT, LTD

100 DEBARTOLO PLACE SUITE 400 BOARDMAN, OHIO 44512
(330) 729-1010

WWW.COCCADEVELOPMENT.COM

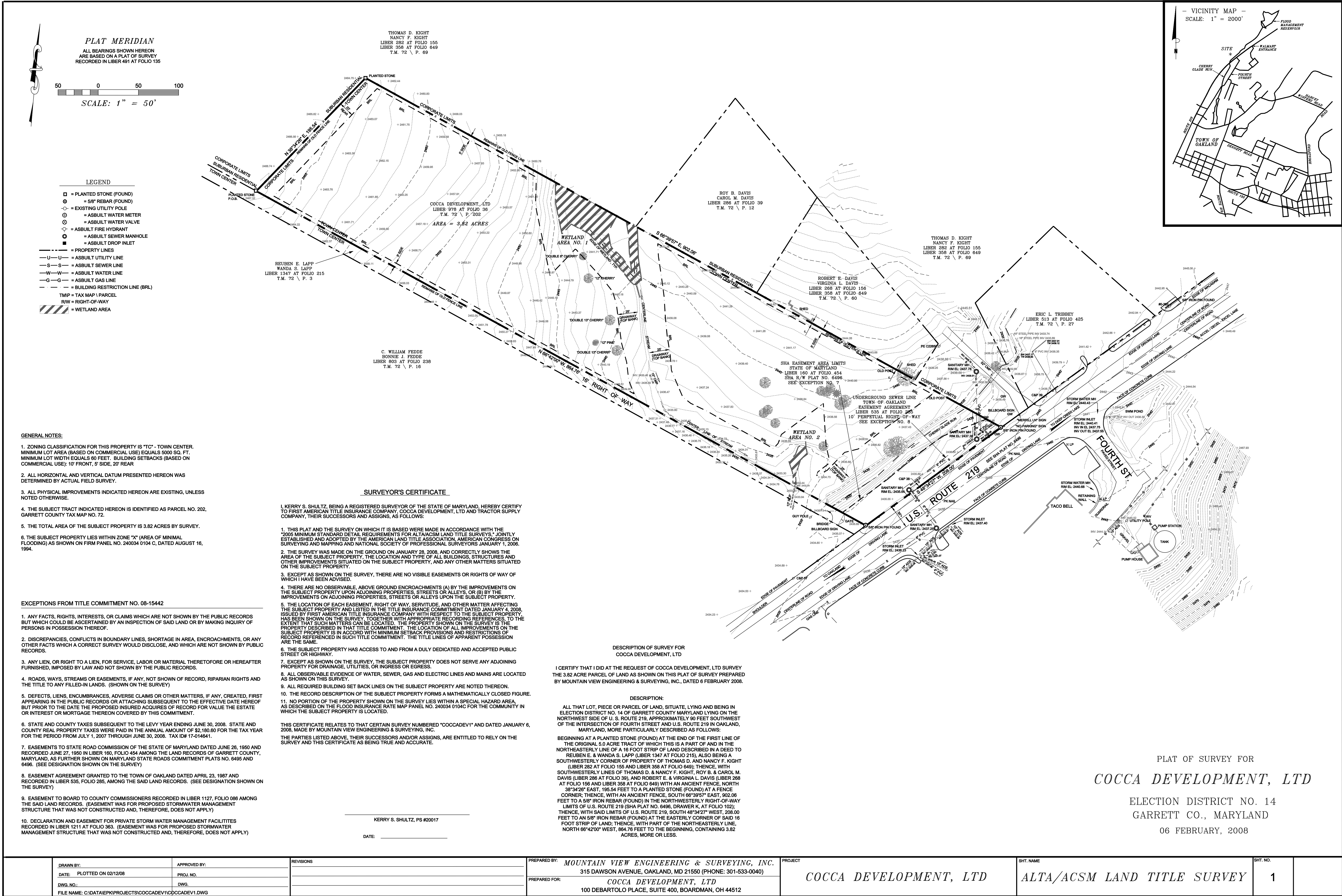



LEGEND (CONTINUED)

○ ○ ○ CLEAN OUT

⚡ FH FIRE HYDRANT

⊞ STORM INLET

○ RECOVERED MONUMENTATION

+ 2437.48 SPOT ELEVATION

⊙ CONTROL POINT / BENCH MARK

☀ TREE (TYPE AS NOTED)

▨ WETLAND AREA

▨ MACADAM SURFACE

--- CORPORATE LIMITS TO THE TOWN OF OAKLAND

LEGEND

--- WETLANDS BUFFER

--- SUBJECT PROPERTY LINE

--- ADJACENT PROPERTY LINE

--- BUILDING RESTRICTION LINE

--- CONTOUR LINE (1' INTERVAL)

--- REFERENCE LINE

--- AERIAL UTILITIES

--- WATER LINE

--- GAS LINE

--- CENTER LINE OF STREAM

--- SANITARY SEWER

⊙ MANHOLE (TYPE AS NOTED)

⊙ UTILITY POLE

⊙ GUY WIRE

⊙ WM WATER METER

⊙ WV WATER VALVE

SITE NOTES

1. THIS SITE LIES WITHIN FLOOD ZONE "C" (AREA OF MINIMAL FLOODING) AS SHOWN ON FIRM PANEL NO. 240034 0104 C, DATED AUGUST 16, 1994.

2. THIS PROPERTY IS IDENTIFIED AS PART OF PARCEL NO. 26 TAX MAP NO. 72.

3. ALL HORIZONTAL AND VERTICAL DATUM PRESENTED HEREON WAS DETERMINED BY ACTUAL FIELD SURVEY.

4. ALL VERTICAL DATUM PRESENTED HEREON IS REFERENCED TO AN ASSUMED SYSTEM.

5. ALL HORIZONTAL DATUM PRESENTED HEREON IS REFERENCED TO MARYLAND STATE MERIDIAN TAKEN FROM SHA PLAT NO. 6496

6. THE LOCATIONS OF UNDERGROUND UTILITIES AS SHOWN HEREON ARE BASED ON ABOVEGROUND STRUCTURES AND RECORD DRAWINGS PROVIDED THE SURVEYOR. LOCATIONS OF UNDERGROUND UTILITIES MAY VARY FROM LOCATIONS SHOWN HEREON. ADDITIONAL BURIED UTILITIES MAY BE ENCOUNTERED. NO EXCAVATIONS WERE MADE DURING THE PROGRESS OF THIS SURVEY TO LOCATE BURIED UTILITIES. BEFORE EXCAVATIONS ARE BEGUN, THE VARIOUS UTILITY COMPANIES SHOULD BE CONTACTED FOR VERIFICATION OF UTILITY TYPE AND FOR FIELD LOCATION.

7. BUILDING SETBACKS: 10' FROM FRONT, 20' FROM REAR, AND 5' AT SIDES. A 25' SETBACK SHALL BE MAINTAINED FROM ALL DRAINWAYS.

8. OAKLAND ZONING DISTRICT: 'TC' - TOWN CENTER DISTRICT

CONTACT LIST

GARRETT COUNTY PLANNING AND ZONING OFFICE
OLD COURTHOUSE, RM. 307
313 E. ALDER STREET
OAKLAND, MARYLAND 21550
PHONE - 301-334-1920
FAX - 301-334-5023
CONTACT PERSON - PLANNER - JIM TORRINGTON

OAKLAND WATER DEPARTMENT
PHONE - 301-334-3836
CONTACT PERSON - SUPERVISOR - RANDY SHARPLESS

OAKLAND SEWER DEPARTMENT
PHONE - 301-334-3533
CONTACT PERSON - SUPERVISOR - JAY MOYER

COLUMBIA GAS
1000 INDUSTRIAL BOULEVARD
CUMBERLAND, MARYLAND 21502
PHONE - 301-784-3363
FAX - 301-759-9331
CONTACT PERSON - PLANT SUPERVISOR - DAVE YATES

CABLE VISION
12 SOUTH THIRD STREET
OAKLAND, MARYLAND 21550
PHONE - 301-334-3763
FAX - 301-334-1786
EMAIL ADDRESS: MIKES@CEWEB.NET
CONTACT PERSON - HEAD TECHNICIAN - MIKE SANDERS

ALLEGHENY POWER COMPANY
700 FOURTH STREET @ SOMERVILLE AVENUE
CUMBERLAND, MARYLAND 21502
PHONE - 301-759-5757
FAX - 301-759-5753
EMAIL ADDRESS: ALLEGHENYPOWER.COM
CONTACT PERSON - BUSINESS ACCOUNTS - JOHN EMERICK

VERIZON (PHONE)
12839 GARRETT HIGHWAY
OAKLAND, MARYLAND 21550
PHONE - 301-759-1858
CONTACT PERSON - ENGINEERS ASSISTANT - PATTY CROSTON

MISS UTILITY (1-800-257-7777)
HANOVER, MARYLAND 21076



COORDINATE FILE: 63078

DWG FILE: 03076

PROFILE PLOT:

FIELD BOOK:

BENNETT, BREWER & ASSOCIATES, LLC

SURVEYORS • ENGINEERS • PLANNERS

17 West Main Street, Frostburg, Maryland 21532

Phone 301-687-0494 FAX 301-687-0495

DRAWN BY: SBM

DESIGN BY: MSB

CHECKED BY: DAB/MSB

APPROVED BY: SKB

WENDY'S INTERNATIONAL INC.

1105 SCHROCK RD. SUITE 401

COLUMBUS, OHIO 43229

BBA PROJECT NO. 2003076

CLIENT PROJECT NO.

SCALE: 1" = 40'

DATE: 6/08/2004

NEW WENDY'S

U.S. ROUTE 219

OAKLAND, GARRETT COUNTY, MARYLAND

EXISTING SITE SURVEY

REVISED 4/07/05

SHEET

C-101



Garrett Hwy
Oakland, MD 21550

Garrett Hwy
Oakland, MD 21550

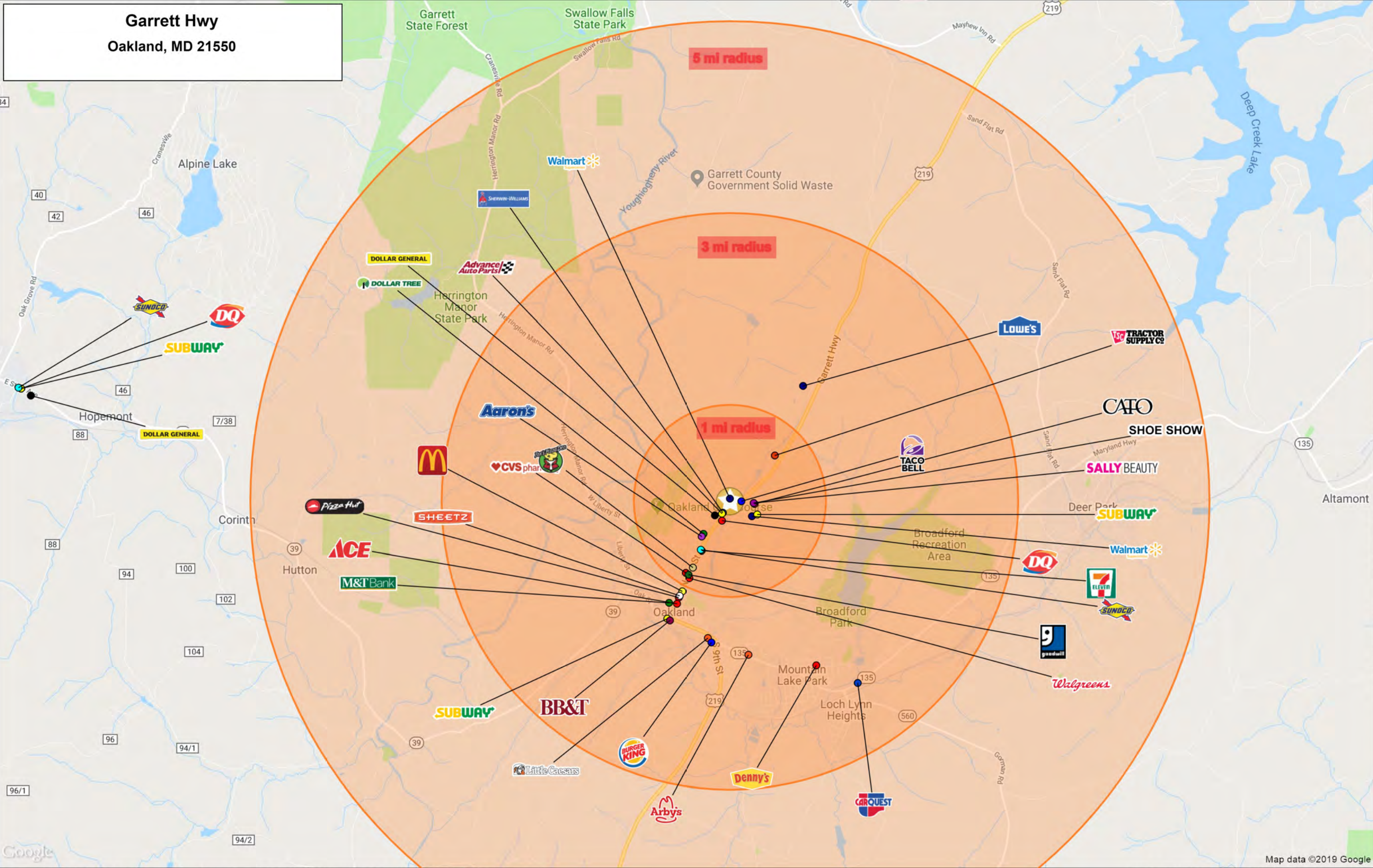

GRAPHIC PROFILE

2000-2010 Census, 2019 Estimates with 2024 Projections

Calculated using Weighted Block Centroid from Block Groups

Lat/Lon: 39.4245/-79.3956

RGRAP3

Garrett Hwy

Oakland, MD 21550

3 mi radius

5 mi radius

10 mi radius

Population

Estimated Population (2019)	6,084	9,750	20,185
Projected Population (2024)	5,908	9,487	19,765
Census Population (2010)	6,350	10,270	20,705
Census Population (2000)	6,609	10,514	20,545
Projected Annual Growth (2019-2024)	-176 -0.6%	-263 -0.5%	-420 -0.4%
Historical Annual Growth (2010-2019)	-266 -0.5%	-520 -0.6%	-520 -0.3%
Historical Annual Growth (2000-2010)	-259 -0.4%	-244 -0.2%	161 -
Estimated Population Density (2019)	215 <i>psm</i>	124 <i>psm</i>	64 <i>psm</i>
Trade Area Size	28.3 <i>sq mi</i>	78.5 <i>sq mi</i>	314.0 <i>sq mi</i>

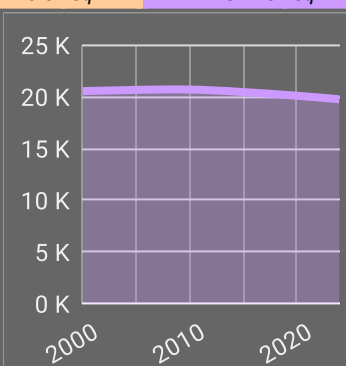
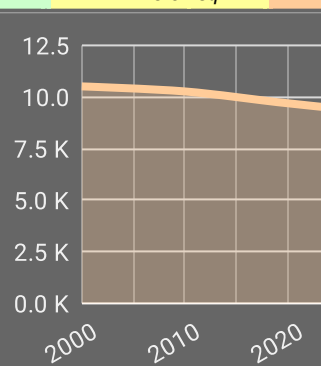
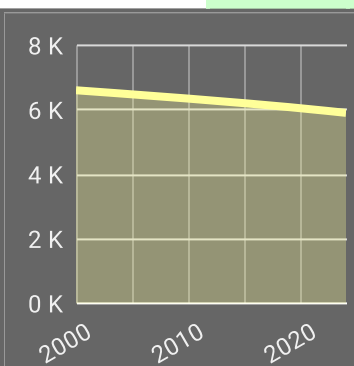

Race and Ethnicity (2019)

Not Hispanic or Latino Population	6,005	98.7%	9,618	98.7%	19,888	98.5%
White	5,864	97.6%	9,406	97.8%	19,350	97.3%
Black or African American	30	0.5%	53	0.6%	232	1.2%
American Indian or Alaska Native	6	0.1%	10	0.1%	28	0.1%
Asian	34	0.6%	52	0.5%	91	0.5%
Hawaiian or Pacific Islander	-	-	-	-	-	-
Other Race	2	-	2	-	2	-
Two or More Races	69	1.2%	95	1.0%	184	0.9%
Hispanic or Latino Population	78	1.3%	132	1.3%	297	1.5%
White	59	74.7%	97	73.4%	209	70.4%
Black or African American	-	-	-	-	6	2.1%
American Indian or Alaska Native	3	4.4%	5	3.8%	7	2.3%
Asian	-	-	1	1.0%	3	0.8%
Hispanic Hawaiian or Pacific Islander	-	-	-	-	-	-
Other Race	3	3.9%	13	10.1%	49	16.4%
Two or More Races	13	16.4%	15	11.6%	24	7.9%

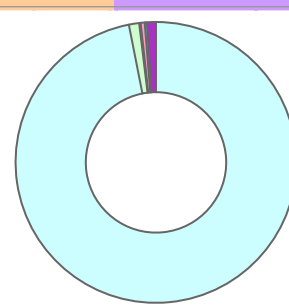
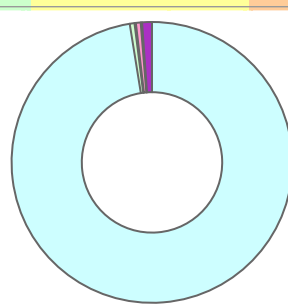
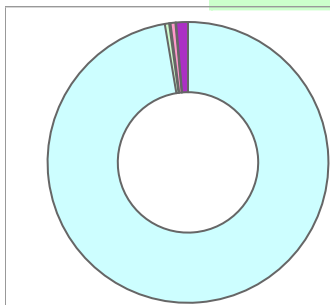

White Black or African American American Indian or Alaska Native Asian Hawaiian or Pacific Islander Other Race 2+ Races

Lat/Lon: 39.4245/-79.3956

RGRAP3

Garrett Hwy

Oakland, MD 21550

3 mi radius 5 mi radius 10 mi radius

Age Distribution (2019)

Age Under 5 Years	317	5.2%	508	5.2%	989	4.9%
Age 5 to 9 Years	298	4.9%	478	4.9%	976	4.8%
Age 10 to 14 Years	309	5.1%	508	5.2%	1,041	5.2%
Age 15 to 19 Years	284	4.7%	480	4.9%	1,048	5.2%
Age 20 to 24 Years	318	5.2%	503	5.2%	1,061	5.3%
Age 25 to 29 Years	390	6.4%	608	6.2%	1,202	6.0%
Age 30 to 34 Years	319	5.2%	522	5.4%	1,055	5.2%
Age 35 to 39 Years	324	5.3%	535	5.5%	1,076	5.3%
Age 40 to 44 Years	308	5.1%	517	5.3%	1,089	5.4%
Age 45 to 49 Years	334	5.5%	560	5.7%	1,235	6.1%
Age 50 to 54 Years	420	6.9%	678	6.9%	1,398	6.9%
Age 55 to 59 Years	493	8.1%	799	8.2%	1,666	8.3%
Age 60 to 64 Years	460	7.6%	751	7.7%	1,661	8.2%
Age 65 to 69 Years	402	6.6%	671	6.9%	1,500	7.4%
Age 70 to 74 Years	388	6.4%	601	6.2%	1,248	6.2%
Age 75 to 79 Years	263	4.3%	429	4.4%	897	4.4%
Age 80 to 84 Years	215	3.5%	304	3.1%	563	2.8%
Age 85 Years or Over	240	4.0%	300	3.1%	480	2.4%
Median Age	46.4		45.7		46.0	

Generation (2019)

iGeneration (Age Under 15 Years)	924	15.2%	1,493	15.3%	3,006	14.9%
Generation 9/11 Millennials (Age 15 to 34 Years)	1,311	21.6%	2,113	21.7%	4,367	21.6%
Gen Xers (Age 35 to 49 Years)	966	15.9%	1,612	16.5%	3,400	16.8%
Baby Boomers (Age 50 to 74 Years)	2,163	35.6%	3,499	35.9%	7,472	37.0%
Silent Generation (Age 75 to 84 Years)	479	7.9%	733	7.5%	1,461	7.2%
G.I. Generation (Age 85 Years or Over)	240	4.0%	300	3.1%	480	2.4%

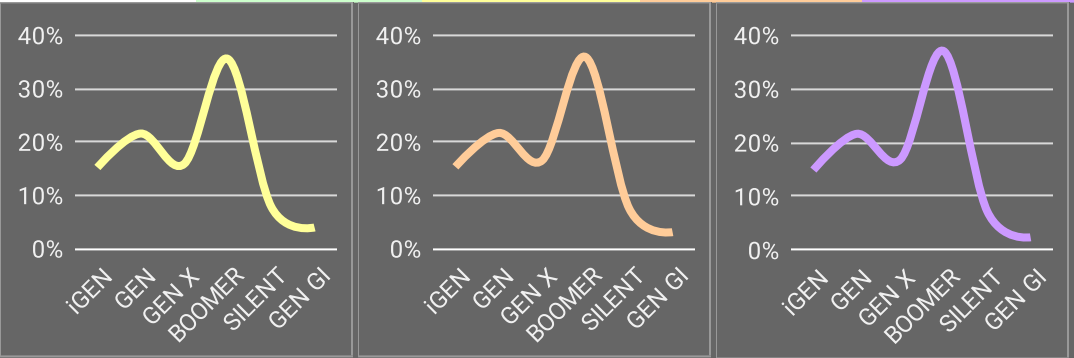

This report was produced using data from private and government sources deemed to be reliable. The information herein is provided without representation or warranty.

GRAPHIC PROFILE

2000-2010 Census, 2019 Estimates with 2024 Projections

Calculated using Weighted Block Centroid from Block Groups

Lat/Lon: 39.4245/-79.3956

RGRAP3

Garrett Hwy

Oakland, MD 21550

3 mi radius

5 mi radius

10 mi radius

Household Type (2019)

Total Households	2,822	4,410	9,006
Family Households	1,627 57.7%	2,745 62.2%	5,809 64.5%
Family Households with Children	712 43.8%	1,142 41.6%	2,212 38.1%
Family Households No Children	915 56.2%	1,603 58.4%	3,597 61.9%
Non-Family Households	1,195 42.3%	1,665 37.8%	3,196 35.5%
Non-Family Households with Children	8 0.7%	11 0.6%	26 0.8%
Non-Family Households No Children	1,187 99.3%	1,654 99.4%	3,171 99.2%

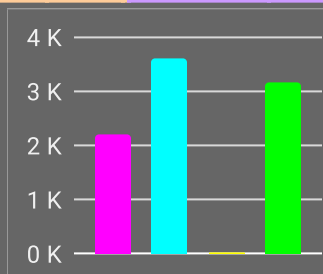
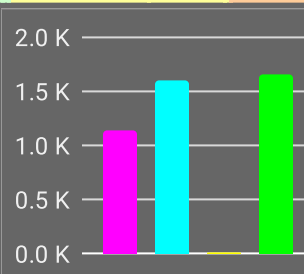
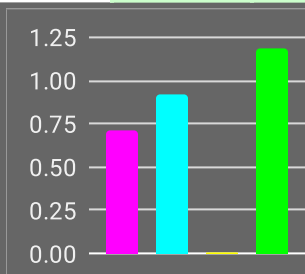

Education Attainment (2019)

Elementary or Some High School	523 11.5%	861 11.8%	1,605 10.6%
High School Graduate	1,878 41.2%	3,089 42.5%	6,462 42.9%
Some College or Associate Degree	1,249 27.4%	1,919 26.4%	3,800 25.2%
Bachelor or Graduate Degree	908 19.9%	1,405 19.3%	3,204 21.3%

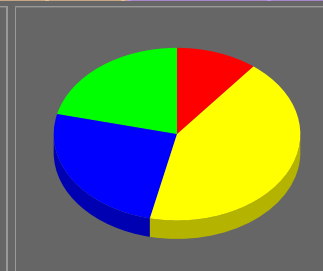
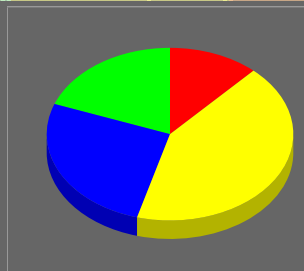
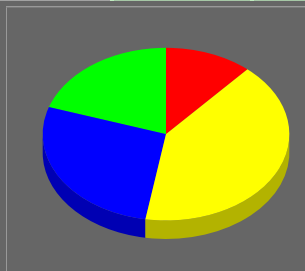

Household Income (2019)

Estimated Average Household Income	\$57,346	\$63,149	\$65,137
Estimated Median Household Income	\$46,194	\$48,961	\$49,393
HH Income Under \$10,000	281 9.9%	332 7.5%	631 7.0%
HH Income \$10,000 to \$34,999	816 28.9%	1,293 29.3%	2,634 29.2%
HH Income \$35,000 to \$49,999	457 16.2%	690 15.7%	1,358 15.1%
HH Income \$50,000 to \$74,999	453 16.1%	777 17.6%	1,669 18.5%
HH Income \$75,000 to \$99,999	350 12.4%	543 12.3%	1,078 12.0%
HH Income \$100,000 to \$149,999	297 10.5%	461 10.4%	945 10.5%
HH Income \$150,000 or More	168 6.0%	314 7.1%	692 7.7%

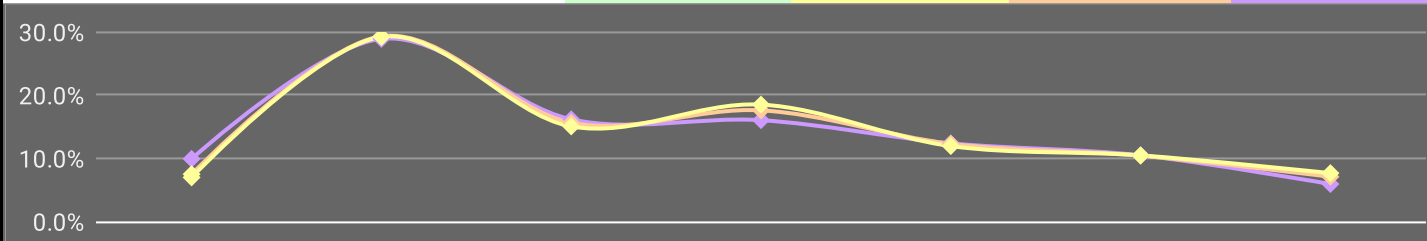

This report was produced using data from private and government sources deemed to be reliable. The information herein is provided without representation or warranty.

EXPANDED PROFILE

2000-2010 Census, 2019 Estimates with 2024 Projections

Calculated using Weighted Block Centroid from Block Groups

Lat/Lon: 39.4245/-79.3956

RF5

Garrett Hwy

Oakland, MD 21550

3 mi radius

5 mi radius

10 mi radius

Population

Estimated Population (2019)	6,084		9,750		20,185	
Projected Population (2024)	5,908		9,487		19,765	
Census Population (2010)	6,350		10,270		20,705	
Census Population (2000)	6,609		10,514		20,545	
Projected Annual Growth (2019 to 2024)	-176	-0.6%	-263	-0.5%	-420	-0.4%
Historical Annual Growth (2010 to 2019)	-266	-0.5%	-520	-0.6%	-520	-0.3%
Historical Annual Growth (2000 to 2010)	-259	-0.4%	-244	-0.2%	161	-
Estimated Population Density (2019)	215	psm	124	psm	64	psm
Trade Area Size	28.3	sq mi	78.5	sq mi	314.0	sq mi

Households

Estimated Households (2019)	2,822		4,410		9,006	
Projected Households (2024)	2,825		4,429		9,090	
Census Households (2010)	2,668		4,199		8,453	
Census Households (2000)	2,600		4,096		8,057	
Estimated Households with Children (2019)	720	25.5%	1,153	26.1%	2,238	24.9%
Estimated Average Household Size (2019)	2.06		2.15		2.20	

Average Household Income

Estimated Average Household Income (2019)	\$57,346		\$63,149		\$65,137	
Projected Average Household Income (2024)	\$69,641		\$76,315		\$77,232	
Estimated Average Family Income (2019)	\$77,946		\$80,129		\$81,507	

Median Household Income

Estimated Median Household Income (2019)	\$46,194		\$48,961		\$49,393	
Projected Median Household Income (2024)	\$53,982		\$56,761		\$57,153	
Estimated Median Family Income (2019)	\$63,401		\$63,731		\$63,710	

Per Capita Income

Estimated Per Capita Income (2019)	\$26,921		\$28,766		\$29,198	
Projected Per Capita Income (2024)	\$33,628		\$35,837		\$35,659	
Estimated Per Capita Income 5 Year Growth	\$6,707	24.9%	\$7,070	24.6%	\$6,461	22.1%
Estimated Average Household Net Worth (2019)	\$336,443		\$362,856		\$390,757	

Daytime Demos (2019)

Total Businesses	650		738		1,190	
Total Employees	7,094		7,651		11,926	
Company Headquarter Businesses	5	0.8%	5	0.7%	7	0.6%
Company Headquarter Employees	653	9.2%	713	9.3%	784	6.6%
Employee Population per Business	10.9		10.4		10.0	
Residential Population per Business	9.4		13.2		17.0	

This report was produced using data from private and government sources deemed to be reliable. The information herein is provided without representation or warranty.

EXPANDED PROFILE

2000-2010 Census, 2019 Estimates with 2024 Projections

Calculated using Weighted Block Centroid from Block Groups

Lat/Lon: 39.4245/-79.3956

RF5

Garrett Hwy

Oakland, MD 21550

Race & Ethnicity

	3 mi radius		5 mi radius		10 mi radius	
White (2019)	5,922	97.3%	9,502	97.5%	19,559	96.9%
Black or African American (2019)	30	0.5%	53	0.5%	238	1.2%
American Indian or Alaska Native (2019)	10	0.2%	15	0.2%	35	0.2%
Asian (2019)	35	0.6%	53	0.5%	94	0.5%
Hawaiian or Pacific Islander (2019)	-	-	-	-	-	-
Other Race (2019)	5	-	15	0.2%	51	0.3%
Two or More Races (2019)	82	1.4%	110	1.1%	208	1.0%
Not Hispanic or Latino Population (2019)	6,005	98.7%	9,618	98.7%	19,888	98.5%
Hispanic or Latino Population (2019)	78	1.3%	132	1.3%	297	1.5%
Not Hispanic or Latino Population (2024)	5,831	98.7%	9,358	98.6%	19,467	98.5%
Hispanic or Latino Population (2024)	77	1.3%	129	1.4%	298	1.5%
Not Hispanic or Latino Population (2010)	6,311	99.4%	10,205	99.4%	20,567	99.3%
Hispanic or Latino Population (2010)	39	0.6%	65	0.6%	138	0.7%
Not Hispanic or Latino Population (2000)	6,568	99.4%	10,464	99.5%	20,451	99.5%
Hispanic or Latino Population (2000)	41	0.6%	49	0.5%	94	0.5%
Projected Hispanic Annual Growth (2019 to 2024)	-1	-0.3%	-3	-0.5%	-	-
Historic Hispanic Annual Growth (2000 to 2019)	38	4.9%	82	8.8%	204	11.4%

Age Distribution (2019)

Age Under 5	317	5.2%	508	5.2%	989	4.9%
Age 5 to 9 Years	298	4.9%	478	4.9%	976	4.8%
Age 10 to 14 Years	309	5.1%	508	5.2%	1,041	5.2%
Age 15 to 19 Years	284	4.7%	480	4.9%	1,048	5.2%
Age 20 to 24 Years	318	5.2%	503	5.2%	1,061	5.3%
Age 25 to 29 Years	390	6.4%	608	6.2%	1,202	6.0%
Age 30 to 34 Years	319	5.2%	522	5.4%	1,055	5.2%
Age 35 to 39 Years	324	5.3%	535	5.5%	1,076	5.3%
Age 40 to 44 Years	308	5.1%	517	5.3%	1,089	5.4%
Age 45 to 49 Years	334	5.5%	560	5.7%	1,235	6.1%
Age 50 to 54 Years	420	6.9%	678	6.9%	1,398	6.9%
Age 55 to 59 Years	493	8.1%	799	8.2%	1,666	8.3%
Age 60 to 64 Years	460	7.6%	751	7.7%	1,661	8.2%
Age 65 to 74 Years	790	13.0%	1,272	13.0%	2,747	13.6%
Age 75 to 84 Years	479	7.9%	733	7.5%	1,461	7.2%
Age 85 Years or Over	240	4.0%	300	3.1%	480	2.4%
Median Age	46.4		45.7		46.0	

Gender Age Distribution (2019)

Female Population	3,241	53.3%	5,087	52.2%	10,274	50.9%
Age 0 to 19 Years	574	17.7%	925	18.2%	1,913	18.6%
Age 20 to 64 Years	1,746	53.9%	2,826	55.6%	5,806	56.5%
Age 65 Years or Over	921	28.4%	1,336	26.3%	2,555	24.9%
Female Median Age	49.2		47.9		47.5	
Male Population	2,843	46.7%	4,663	47.8%	9,911	49.1%
Age 0 to 19 Years	635	22.3%	1,048	22.5%	2,141	21.6%
Age 20 to 64 Years	1,620	57.0%	2,645	56.7%	5,637	56.9%
Age 65 Years or Over	588	20.7%	969	20.8%	2,132	21.5%
Male Median Age	43.3		43.4		44.5	

This report was produced using data from private and government sources deemed to be reliable. The information herein is provided without representation or warranty.

EXPANDED PROFILE

2000-2010 Census, 2019 Estimates with 2024 Projections

Calculated using Weighted Block Centroid from Block Groups

Lat/Lon: 39.4245/-79.3956

RF5

Garrett Hwy

Oakland, MD 21550

3 mi radius

5 mi radius

10 mi radius

Household Income Distribution (2019)

HH Income \$200,000 or More	72	2.6%	122	2.8%	327	3.6%
HH Income \$150,000 to \$199,999	96	3.4%	191	4.3%	365	4.1%
HH Income \$100,000 to \$149,999	297	10.5%	461	10.4%	945	10.5%
HH Income \$75,000 to \$99,999	350	12.4%	543	12.3%	1,078	12.0%
HH Income \$50,000 to \$74,999	453	16.1%	777	17.6%	1,669	18.5%
HH Income \$35,000 to \$49,999	457	16.2%	690	15.7%	1,358	15.1%
HH Income \$25,000 to \$34,999	252	8.9%	444	10.1%	943	10.5%
HH Income \$15,000 to \$24,999	337	11.9%	550	12.5%	1,159	12.9%
HH Income Under \$15,000	508	18.0%	631	14.3%	1,162	12.9%
HH Income \$35,000 or More	1,725	61.1%	2,785	63.2%	5,741	63.7%
HH Income \$75,000 or More	815	28.9%	1,317	29.9%	2,715	30.1%

Housing (2019)

Total Housing Units	3,180		5,546		14,206	
Housing Units Occupied	2,822	88.7%	4,410	79.5%	9,006	63.4%
Housing Units Owner-Occupied	1,862	66.0%	3,200	72.6%	6,912	76.8%
Housing Units, Renter-Occupied	960	34.0%	1,210	27.4%	2,094	23.2%
Housing Units, Vacant	358	12.7%	1,136	25.8%	5,200	57.7%

Marital Status (2019)

Never Married	1,489	28.9%	2,215	26.8%	4,284	24.9%
Currently Married	2,377	46.1%	4,169	50.5%	9,142	53.2%
Separated	212	4.1%	314	3.8%	530	3.1%
Widowed	496	9.6%	734	8.9%	1,388	8.1%
Divorced	586	11.4%	826	10.0%	1,835	10.7%

Household Type (2019)

Population Family	4,452	73.2%	7,581	77.8%	16,044	79.5%
Population Non-Family	1,358	22.3%	1,891	19.4%	3,728	18.5%
Population Group Quarters	274	4.5%	279	2.9%	413	2.0%
Family Households	1,627	57.7%	2,745	62.2%	5,809	64.5%
Non-Family Households	1,195	42.3%	1,665	37.8%	3,196	35.5%
Married Couple with Children	432	18.2%	740	17.8%	1,516	16.6%
Average Family Household Size	2.7		2.8		2.8	

Household Size (2019)

1 Person Households	1,055	37.4%	1,479	33.5%	2,789	31.0%
2 Person Households	1,042	36.9%	1,718	39.0%	3,685	40.9%
3 Person Households	327	11.6%	530	12.0%	1,097	12.2%
4 Person Households	263	9.3%	440	10.0%	906	10.1%
5 Person Households	85	3.0%	150	3.4%	322	3.6%
6 or More Person Households	49	1.7%	94	2.1%	206	2.3%

Household Vehicles (2019)

Households with 0 Vehicles Available	375	13.3%	459	10.4%	709	7.9%
Households with 1 Vehicles Available	950	33.7%	1,443	32.7%	3,003	33.3%
Households with 2 or More Vehicles Available	1,497	53.0%	2,507	56.9%	5,294	58.8%
Total Vehicles Available	4,709		7,808		16,455	
Average Vehicles Per Household	1.7		1.8		1.8	

This report was produced using data from private and government sources deemed to be reliable. The information herein is provided without representation or warranty.

EXPANDED PROFILE

2000-2010 Census, 2019 Estimates with 2024 Projections

Calculated using Weighted Block Centroid from Block Groups

Lat/Lon: 39.4245/-79.3956

RF5

Garrett Hwy

Oakland, MD 21550

3 mi radius

5 mi radius

10 mi radius

Labor Force (2019)

Estimated Labor Population Age 16 Years or Over	5,106		8,159		16,983	
Estimated Civilian Employed	2,654	52.0%	4,335	53.1%	8,910	52.5%
Estimated Civilian Unemployed	150	2.9%	213	2.6%	424	2.5%
Estimated in Armed Forces	-	-	-	-	14	-
Estimated Not in Labor Force	2,302	45.1%	3,611	44.3%	7,635	45.0%
Unemployment Rate	2.9%		2.6%		2.5%	

Occupation (2019)

Occupation: Population Age 16 Years or Over	2,654		4,335		8,910	
Management, Business, Financial Operations	348	13.1%	643	14.8%	1,313	14.7%
Professional, Related	514	19.4%	852	19.7%	1,653	18.6%
Service	546	20.6%	758	17.5%	1,563	17.5%
Sales, Office	579	21.8%	892	20.6%	1,770	19.9%
Farming, Fishing, Forestry	11	0.4%	25	0.6%	54	0.6%
Construct, Extraction, Maintenance	319	12.0%	615	14.2%	1,476	16.6%
Production, Transport Material Moving	337	12.7%	550	12.7%	1,081	12.1%
White Collar Workers	1,441	54.3%	2,387	55.1%	4,736	53.2%
Blue Collar Workers	1,213	45.7%	1,948	44.9%	4,174	46.8%

Consumer Expenditure (2019)

Total Household Expenditure	\$135.2 M		\$225.37 M		\$469.9 M	
Total Non-Retail Expenditure	\$71.51 M	52.9%	\$119 M	52.8%	\$247.99 M	52.8%
Total Retail Expenditure	\$63.69 M	47.1%	\$106.37 M	47.2%	\$221.91 M	47.2%
Apparel	\$4.65 M	3.4%	\$7.76 M	3.4%	\$16.18 M	3.4%
Contributions	\$4.27 M	3.2%	\$7.18 M	3.2%	\$15.12 M	3.2%
Education	\$3.7 M	2.7%	\$6.17 M	2.7%	\$12.95 M	2.8%
Entertainment	\$7.46 M	5.5%	\$12.51 M	5.6%	\$26.18 M	5.6%
Food and Beverages	\$20.11 M	14.9%	\$33.44 M	14.8%	\$69.58 M	14.8%
Furnishings and Equipment	\$4.64 M	3.4%	\$7.79 M	3.5%	\$16.28 M	3.5%
Gifts	\$3.14 M	2.3%	\$5.25 M	2.3%	\$11.05 M	2.4%
Health Care	\$11.86 M	8.8%	\$19.8 M	8.8%	\$41.27 M	8.8%
Household Operations	\$5.25 M	3.9%	\$8.79 M	3.9%	\$18.38 M	3.9%
Miscellaneous Expenses	\$2.56 M	1.9%	\$4.27 M	1.9%	\$8.9 M	1.9%
Personal Care	\$1.81 M	1.3%	\$3.02 M	1.3%	\$6.3 M	1.3%
Personal Insurance	\$901.97 K	0.7%	\$1.53 M	0.7%	\$3.21 M	0.7%
Reading	\$297.02 K	0.2%	\$496.36 K	0.2%	\$1.04 M	0.2%
Shelter	\$28.76 M	21.3%	\$47.65 M	21.1%	\$98.98 M	21.1%
Tobacco	\$922.1 K	0.7%	\$1.5 M	0.7%	\$3.09 M	0.7%
Transportation	\$24.39 M	18.0%	\$40.84 M	18.1%	\$85.28 M	18.1%
Utilities	\$10.48 M	7.8%	\$17.38 M	7.7%	\$36.1 M	7.7%

Educational Attainment (2019)

Adult Population Age 25 Years or Over	4,558		7,274		15,070	
Elementary (Grade Level 0 to 8)	182	4.0%	286	3.9%	543	3.6%
Some High School (Grade Level 9 to 11)	341	7.5%	576	7.9%	1,062	7.0%
High School Graduate	1,878	41.2%	3,089	42.5%	6,462	42.9%
Some College	836	18.4%	1,281	17.6%	2,568	17.0%
Associate Degree Only	413	9.1%	638	8.8%	1,231	8.2%
Bachelor Degree Only	453	9.9%	721	9.9%	1,656	11.0%
Graduate Degree	455	10.0%	684	9.4%	1,548	10.3%

This report was produced using data from private and government sources deemed to be reliable. The information herein is provided without representation or warranty.

EXPANDED PROFILE

2000-2010 Census, 2019 Estimates with 2024 Projections

Calculated using Weighted Block Centroid from Block Groups

Lat/Lon: 39.4245/-79.3956

RF5

Garrett Hwy

Oakland, MD 21550

Units In Structure (2019)

	3 mi radius		5 mi radius		10 mi radius	
1 Detached Unit	2,060	77.2%	3,375	80.4%	7,089	83.9%
1 Attached Unit	81	3.1%	132	3.2%	272	3.2%
2 to 4 Units	113	4.2%	141	3.4%	220	2.6%
5 to 9 Units	149	5.6%	165	3.9%	283	3.4%
10 to 19 Units	39	1.5%	55	1.3%	75	0.9%
20 to 49 Units	204	7.7%	216	5.1%	232	2.7%
50 or More Units	54	2.0%	66	1.6%	71	0.8%
Mobile Home or Trailer	121	4.5%	260	6.2%	763	9.0%
Other Structure	-	-	-	-	-	-

Homes Built By Year (2019)

Homes Built 2010 or later	83	3.1%	118	2.8%	257	3.0%
Homes Built 2000 to 2009	287	10.7%	583	13.9%	1,280	15.1%
Homes Built 1990 to 1999	440	16.5%	667	15.9%	1,327	15.7%
Homes Built 1980 to 1989	467	17.5%	697	16.6%	1,411	16.7%
Homes Built 1970 to 1979	462	17.3%	692	16.5%	1,504	17.8%
Homes Built 1960 to 1969	171	6.4%	287	6.8%	620	7.3%
Homes Built 1950 to 1959	306	11.5%	463	11.0%	682	8.1%
Homes Built Before 1949	607	22.7%	904	21.5%	1,925	22.8%

Home Values (2019)

Home Values \$1,000,000 or More	-	-	15	0.5%	96	1.5%
Home Values \$500,000 to \$999,999	49	2.8%	152	5.0%	500	7.7%
Home Values \$400,000 to \$499,999	65	3.7%	132	4.4%	341	5.3%
Home Values \$300,000 to \$399,999	181	10.3%	276	9.1%	509	7.9%
Home Values \$200,000 to \$299,999	282	16.1%	507	16.7%	1,031	15.9%
Home Values \$150,000 to \$199,999	366	20.8%	682	22.5%	1,193	18.4%
Home Values \$100,000 to \$149,999	433	24.7%	615	20.3%	1,116	17.2%
Home Values \$70,000 to \$99,999	221	12.6%	360	11.9%	847	13.1%
Home Values \$50,000 to \$69,999	89	5.1%	167	5.5%	478	7.4%
Home Values \$25,000 to \$49,999	65	3.7%	129	4.3%	338	5.2%
Home Values Under \$25,000	94	5.3%	141	4.6%	416	6.4%
Owner-Occupied Median Home Value	\$152,545		\$168,907		\$178,698	
Renter-Occupied Median Rent	\$463		\$465		\$462	

Transportation To Work (2019)

Drive to Work Alone	2,204	77.7%	3,606	79.5%	7,235	78.8%
Drive to Work in Carpool	301	10.6%	424	9.3%	904	9.8%
Travel to Work by Public Transportation	9	0.3%	18	0.4%	63	0.7%
Drive to Work on Motorcycle	-	-	-	-	1	-
Walk or Bicycle to Work	145	5.1%	202	4.5%	303	3.3%
Other Means	38	1.3%	49	1.1%	54	0.6%
Work at Home	138	4.9%	238	5.2%	627	6.8%

Travel Time (2019)

Travel to Work in 14 Minutes or Less	1,389	49.0%	1,918	42.3%	2,979	32.4%
Travel to Work in 15 to 29 Minutes	634	22.3%	1,331	29.3%	3,015	32.8%
Travel to Work in 30 to 59 Minutes	379	13.4%	623	13.7%	1,661	18.1%
Travel to Work in 60 Minutes or More	130	4.6%	245	5.4%	659	7.2%
Average Minutes Travel to Work	12.3		14.1		18.6	

This report was produced using data from private and government sources deemed to be reliable. The information herein is provided without representation or warranty.