

RETAIL SPACE FOR LEASE

4415 North Leavitt Road  
Lorain, OH 44053

\$21/sf + NNN\*

\*\$3/sf NNN includes Real Estate Taxes & Insurance and CAM (such as parking lot maintenance, snow removal, lawn care, etc.)

Aerial – Site View



Demographic Data

	1 mi	5 mi	10 mi
Estimated Population (2023)	9,694	95,298	226,693
Projected Population (2028)	9,493	94,458	234,785
Estimated Households (2023)	4,414	38,676	93,724
Projected Households (2028)	4,274	38,089	96,502
Estimated Average Household Income (2023)	\$75,287	\$79,725	\$92,805
Projected Average Household Income (2028)	\$83,034	\$87,205	\$97,321
Total Businesses	258	2,353	6,035
Total Employees	1,618	29,048	71,285

Space Details



Join TJ Maxx and Five Below in new center currently under construction across from the new Firestone also under construction and next to Mattress Firm

Approximately 14,734 sf available – can be split per tenant needs

Large parking lot with tenant pylon sign

“Hot” growing retail area

**COCCA DEVELOPMENT, LTD**  
100 DEBARTOLO PLACE SUITE 400 BOARDMAN, OHIO 44512  
(330) 729-1010  
[WWW.COCCADEVELOPMENT.COM](http://WWW.COCCADEVELOPMENT.COM)



I:\Land Projects\2006 Drawing After 6-12\Lorain, OH (TJ Max & Plaza 2022)\Drawings\05 Preliminary\24-0209 - Master Plan - Lorain OH (2024).dwg, 2/12/2024 9:49:44 AM

SITE

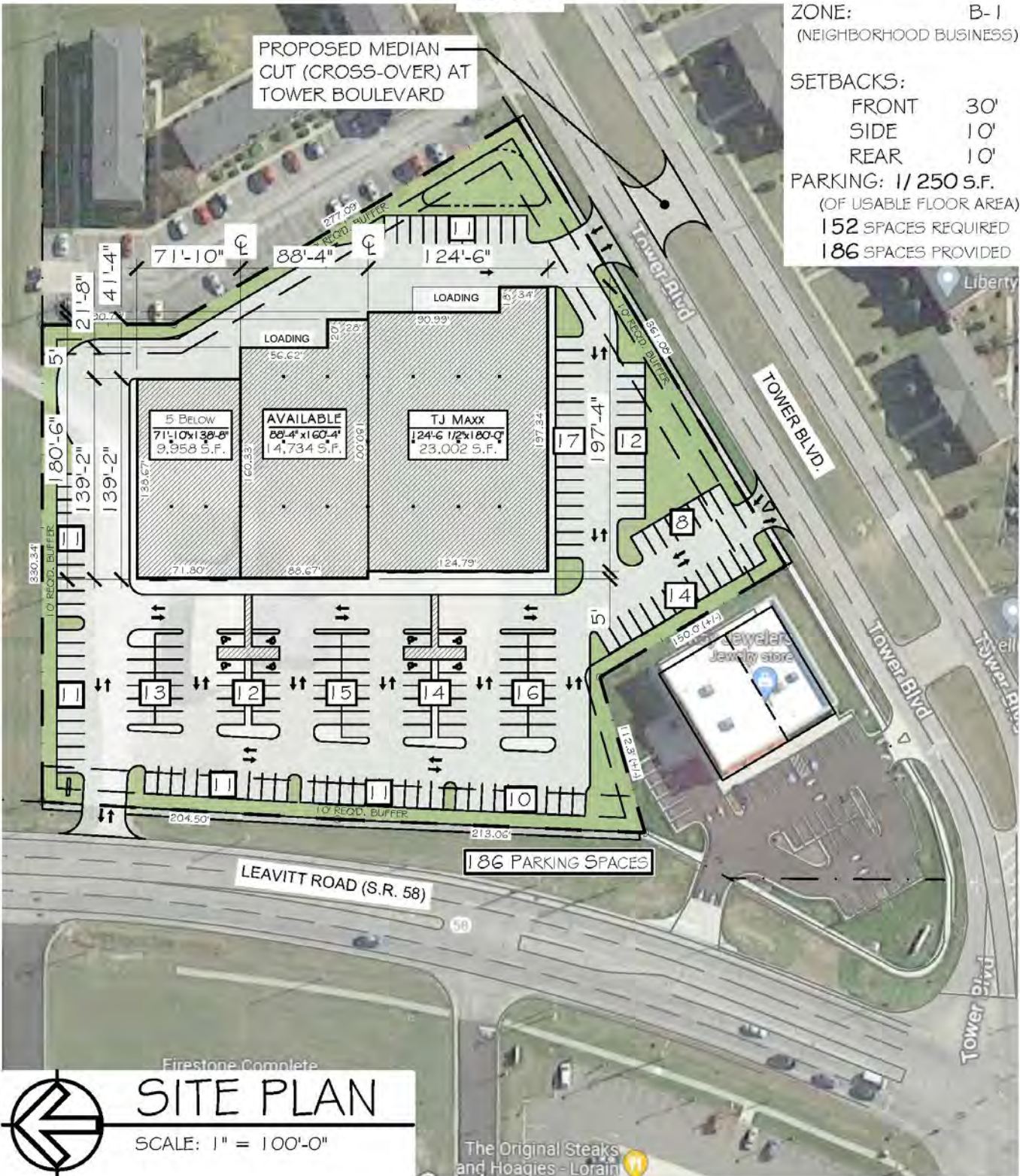

PRELIMINARY LAYOUT PLAN			CITY, STATE - STREET: 4415 NORTH LEAVITT ROAD * LORAIN, OH 44053 LORAIN COUNTY (* EXISTING ADDRESS)	DATE:
TENANT:	DEVELOPER		DESIGNER	2/27/23
PROJECT SIZE:	COMPANY: COCCA DEVELOPMENT		COMPANY: COCCA DEVELOPMENT	3/23/23
BLDG. SIZE: 47,694 S.F.	NAME: ANTHONY COCCA		NAME: BILL SCHROEDER	2/9/24
LOT SIZE: 4.00 ACRES	PHONE #: 330-729-1010		PHONE #: 330-729-1010	
PARKING: 186 SPACES				



I:\Land Projects\2006 Drawing After 6-12\Lorain, OH (TJ Max & Plaza 2022)\Drawings\05 Preliminary\24-0209 - Master Plan - Lorain OH (2024).dwg, 2/12/2024 9:49:49 AM

OVERALL



PRELIMINARY LAYOUT PLAN			CITY, STATE - STREET: 4415 NORTH LEAVITT ROAD * LORAIN, OH 44053 LORAIN COUNTY (* EXISTING ADDRESS)	DATE:
TENANT:	DEVELOPER		DESIGNER	2/27/23
PROJECT SIZE:	COMPANY: COCCA DEVELOPMENT		COMPANY: COCCA DEVELOPMENT	3/23/23
BLDG. SIZE: 47,694 S.F.	NAME: ANTHONY COCCA		NAME: BILL SCHROEDER	2/9/24
LOT SIZE: 4.00 ACRES	PHONE #: 330-729-1010		PHONE #: 330-729-1010	
PARKING: 186 SPACES				



I:\Land Projects\2006 Drawing After G-12\Lorain, OH (TJ Max & Plaza 2022)\Drawings\05 Preliminary\24-0209 - Master Plan - Lorain OH (2024).dwg, 2/12/2024 9:49:47 AM

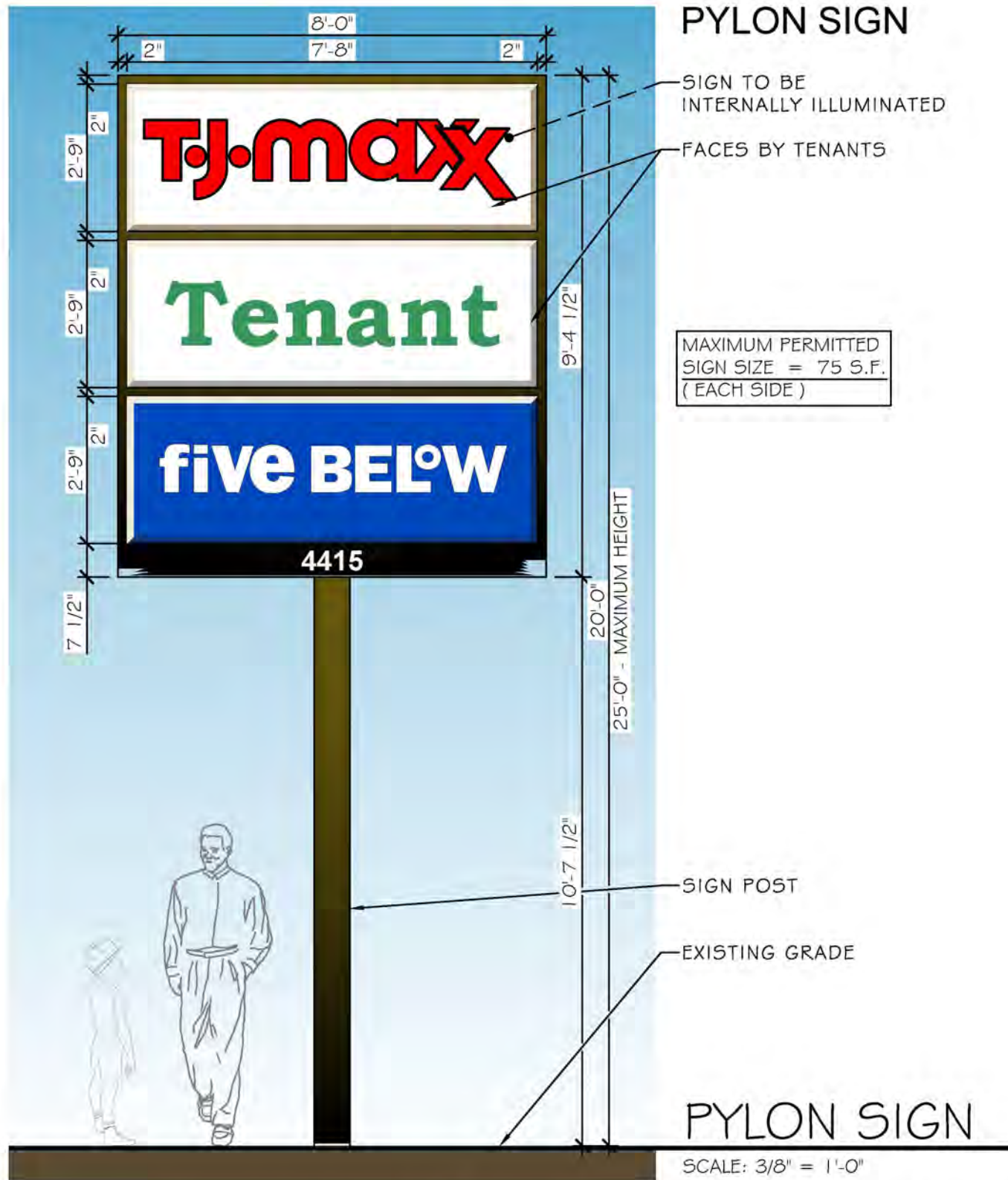

PRELIMINARY LAYOUT PLAN		CITY, STATE - STREET: 4415 NORTH LEAVITT ROAD * LORAIN, OH 44053 LORAIN COUNTY (* EXISTING ADDRESS)		DATE:
TENANT:	DEVELOPER	DESIGNER		2/6/23
PROJECT SIZE:	COMPANY: COCCA DEVELOPMENT	COMPANY: COCCA DEVELOPMENT		2/27/23
BLDG. SIZE: 47,694 S.F.	NAME: ANTHONY COCCA	NAME: BILL SCHROEDER		3/23/23
LOT SIZE: 4.00 ACRES	PHONE #: 330-729-1010	PHONE #: 330-729-1010		2/9/24
PARKING: 186 SPACES				







Graphic Profile

2010-2020 Census, 2023 Estimates with 2028 Projections

Calculated using Weighted Block Centroid from Block Groups

Lat/Lon: 41.4302/-82.2015

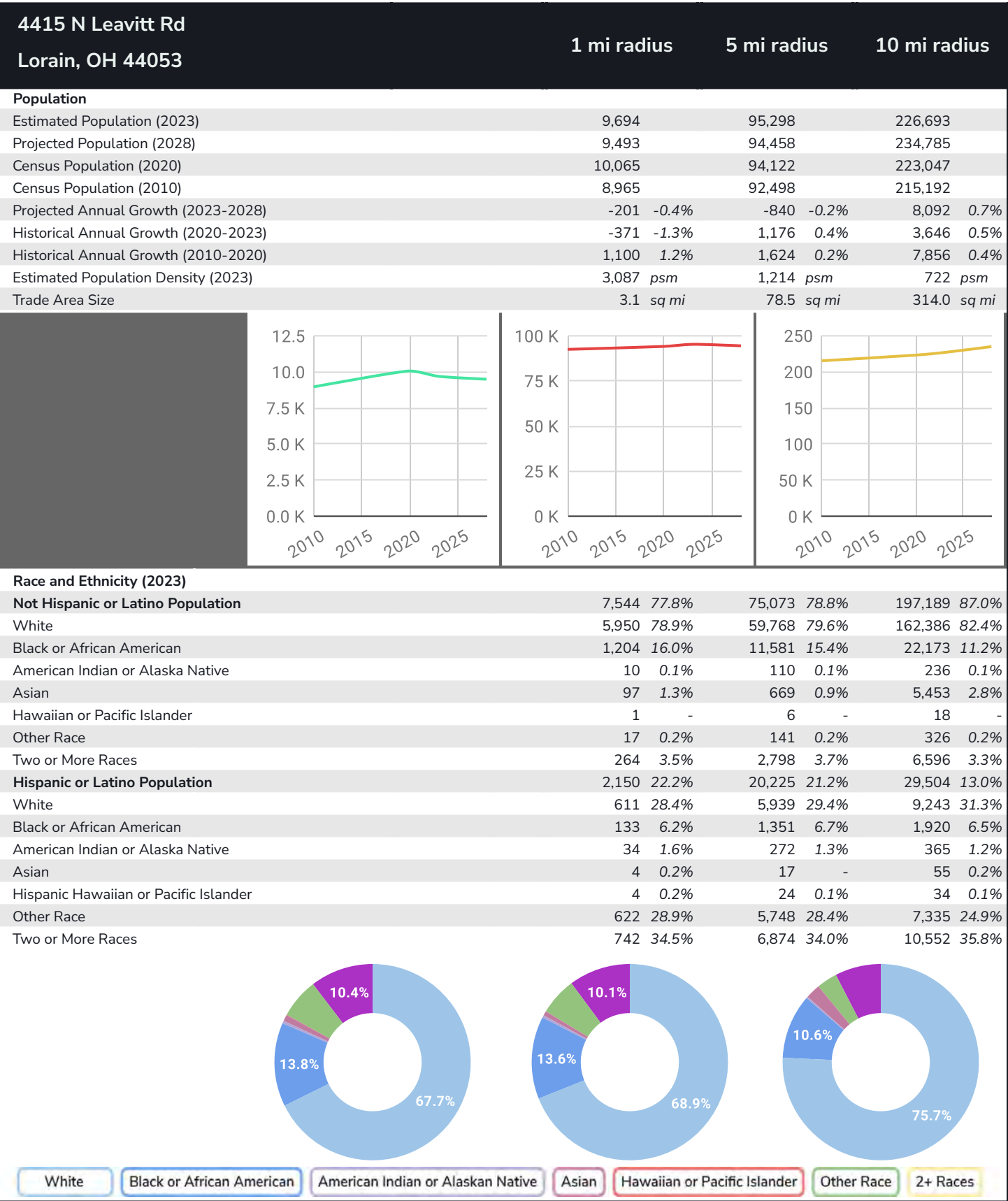

250

200

150

100

50 K

0 K

2010

2015

2020

2025

Race and Ethnicity (2023)

Not Hispanic or Latino Population

White

Black or African American

American Indian or Alaska Native

Asian

Hawaiian or Pacific Islander

Other Race

Two or More Races

Hispanic or Latino Population

White

Black or African American

American Indian or Alaska Native

Asian

Hispanic Hawaiian or Pacific Islander

Other Race

Two or More Races

10.4%

13.8%

67.7%

10.1%

13.6%

68.9%

10.6%

13.6%

75.7%

White

Black or African American

American Indian or Alaskan Native

Asian

Hawaiian or Pacific Islander

Other Race

2+ Races

Lat/Lon: 41.4302/-82.2015

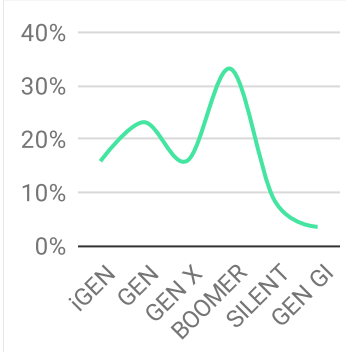
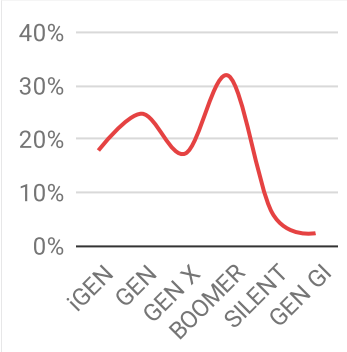
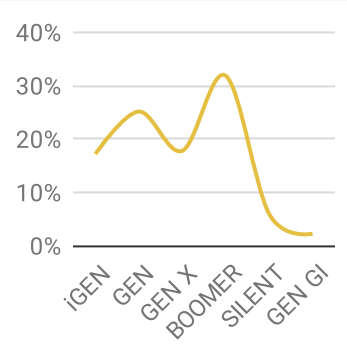
4415 N Leavitt Rd Lorain, OH 44053		1 mi radius		5 mi radius		10 mi radius	
Age Distribution (2023)							
Age Under 5 Years	520	5.4%	5,237	5.5%	12,210	5.4%	
Age 5 to 9 Years	514	5.3%	5,672	6.0%	13,161	5.8%	
Age 10 to 14 Years	497	5.1%	6,066	6.4%	13,526	6.0%	
Age 15 to 19 Years	478	4.9%	5,935	6.2%	13,761	6.1%	
Age 20 to 24 Years	548	5.6%	5,977	6.3%	14,996	6.6%	
Age 25 to 29 Years	630	6.5%	5,897	6.2%	13,911	6.1%	
Age 30 to 34 Years	586	6.0%	5,734	6.0%	14,255	6.3%	
Age 35 to 39 Years	539	5.6%	5,452	5.7%	13,701	6.0%	
Age 40 to 44 Years	512	5.3%	5,502	5.8%	13,577	6.0%	
Age 45 to 49 Years	490	5.1%	5,481	5.8%	12,980	5.7%	
Age 50 to 54 Years	583	6.0%	6,265	6.6%	14,698	6.5%	
Age 55 to 59 Years	615	6.3%	6,221	6.5%	15,019	6.6%	
Age 60 to 64 Years	738	7.6%	6,587	6.9%	15,835	7.0%	
Age 65 to 69 Years	647	6.7%	5,903	6.2%	14,298	6.3%	
Age 70 to 74 Years	627	6.5%	5,311	5.6%	12,274	5.4%	
Age 75 to 79 Years	503	5.2%	3,534	3.7%	8,243	3.6%	
Age 80 to 84 Years	328	3.4%	2,311	2.4%	5,190	2.3%	
Age 85 Years or Over	340	3.5%	2,213	2.3%	5,056	2.2%	
Median Age	44.5		40.8		40.8		
Generation (2023)							
iGeneration (Age Under 15 Years)	1,531	15.8%	16,974	17.8%	38,897	17.2%	
Generation 9/11 Millennials (Age 15 to 34 Years)	2,241	23.1%	23,544	24.7%	56,922	25.1%	
Gen Xers (Age 35 to 49 Years)	1,541	15.9%	16,434	17.2%	40,258	17.8%	
Baby Boomers (Age 50 to 74 Years)	3,210	33.1%	30,288	31.8%	72,125	31.8%	
Silent Generation (Age 75 to 84 Years)	831	8.6%	5,845	6.1%	13,434	5.9%	
G.I. Generation (Age 85 Years or Over)	340	3.5%	2,213	2.3%	5,056	2.2%	
							

## Graphic Profile

2010-2020 Census, 2023 Estimates with 2028 Projections  
Calculated using Weighted Block Centroid from Block Groups

Lat/Lon: 41.4302/-82.2015

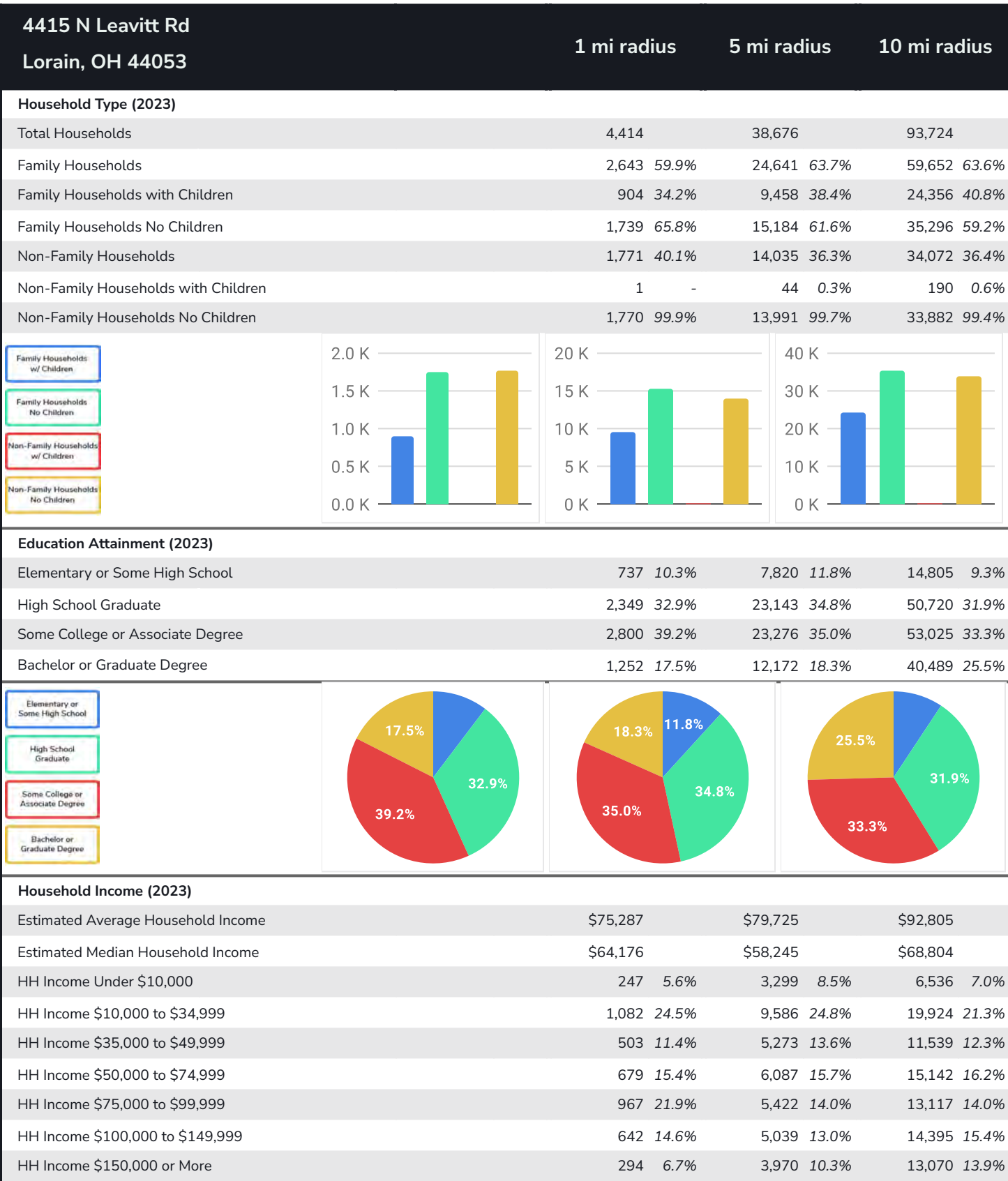



## Expanded Profile

2010-2020 Census, 2023 Estimates with 2028 Projections  
Calculated using Weighted Block Centroid from Block Groups

Lat/Lon: 41.4302/-82.2015

4415 N Leavitt Rd Lorain, OH 44053	1 mi radius		5 mi radius		10 mi radius	
Population						
Estimated Population (2023)	9,694		95,298		226,693	
Projected Population (2028)	9,493		94,458		234,785	
Census Population (2020)	10,065		94,122		223,047	
Census Population (2010)	8,965		92,498		215,192	
Projected Annual Growth (2023 to 2028)	-201	-0.4%	-840	-0.2%	8,092	0.7%
Historical Annual Growth (2020 to 2023)	-371	-1.2%	1,176	0.4%	3,646	0.5%
Historical Annual Growth (2010 to 2020)	1,100	4.1%	1,624	0.6%	7,856	1.2%
Estimated Population Density (2023)	3,087	psm	1,214	psm	722	psm
Trade Area Size	3.1	sq mi	78.5	sq mi	314.0	sq mi
Households						
Estimated Households (2023)	4,414		38,676		93,724	
Projected Households (2028)	4,274		38,089		96,502	
Census Households (2020)	4,558		38,841		91,595	
Census Households (2010)	4,022		37,084		85,417	
Estimated Households with Children (2023)	905	20.5%	9,502	24.6%	24,546	26.2%
Estimated Average Household Size (2023)	2.18		2.44		2.36	
Average Household Income						
Estimated Average Household Income (2023)	\$75,287		\$79,725		\$92,805	
Projected Average Household Income (2028)	\$83,034		\$87,205		\$97,321	
Estimated Average Family Income (2023)	\$92,120		\$90,440		\$109,775	
Median Household Income						
Estimated Median Household Income (2023)	\$64,176		\$58,245		\$68,804	
Projected Median Household Income (2028)	\$63,405		\$58,894		\$69,663	
Estimated Median Family Income (2023)	\$77,171		\$74,778		\$86,942	
Per Capita Income						
Estimated Per Capita Income (2023)	\$34,371		\$32,456		\$38,553	
Projected Per Capita Income (2028)	\$37,473		\$35,265		\$40,179	
Estimated Per Capita Income 5 Year Growth	\$3,102	9.0%	\$2,810	8.7%	\$1,626	4.2%
Estimated Average Household Net Worth (2023)	\$211,084		\$290,807		\$360,212	
Daytime Demos (2023)						
Total Businesses	258		2,353		6,035	
Total Employees	1,618		29,048		71,285	
Company Headquarter Businesses	8	2.9%	79	3.3%	202	3.4%
Company Headquarter Employees	128	7.9%	6,716	23.1%	13,456	18.9%
Employee Population per Business	6.3		12.3		11.8	
Residential Population per Business	37.5		40.5		37.6	



## Expanded Profile

2010-2020 Census, 2023 Estimates with 2028 Projections  
Calculated using Weighted Block Centroid from Block Groups

Lat/Lon: 41.4302/-82.2015

### 4415 N Leavitt Rd

Lorain, OH 44053

1 mi radius

5 mi radius

10 mi radius

#### Race & Ethnicity

White (2023)	6,561	67.7%	65,708	68.9%	171,630	75.7%
Black or African American (2023)	1,337	13.8%	12,932	13.6%	24,093	10.6%
American Indian or Alaska Native (2023)	43	0.4%	382	0.4%	601	0.3%
Asian (2023)	101	1.0%	687	0.7%	5,509	2.4%
Hawaiian or Pacific Islander (2023)	5	-	30	-	52	-
Other Race (2023)	639	6.6%	5,888	6.2%	7,661	3.4%
Two or More Races (2023)	1,007	10.4%	9,671	10.1%	17,148	7.6%
Not Hispanic or Latino Population (2023)	7,544	77.8%	75,073	78.8%	197,189	87.0%
Hispanic or Latino Population (2023)	2,150	22.2%	20,225	21.2%	29,504	13.0%
Not Hispanic or Latino Population (2028)	7,398	77.9%	75,020	79.4%	205,437	87.5%
Hispanic or Latino Population (2028)	2,095	22.1%	19,438	20.6%	29,348	12.5%
Not Hispanic or Latino Population (2020)	7,649	76.0%	71,940	76.4%	193,235	86.6%
Hispanic or Latino Population (2020)	2,416	24.0%	22,181	23.6%	29,813	13.4%
Not Hispanic or Latino Population (2010)	7,310	81.5%	74,403	80.4%	191,870	89.2%
Hispanic or Latino Population (2010)	1,655	18.5%	18,095	19.6%	23,322	10.8%
Projected Hispanic Annual Growth (2023 to 2028)	-55	-0.5%	-787	-0.8%	-157	-0.1%
Historic Hispanic Annual Growth (2010 to 2023)	496	2.3%	2,130	0.9%	6,183	2.0%

#### Age Distribution (2023)

Age Under 5	520	5.4%	5,237	5.5%	12,210	5.4%
Age 5 to 9 Years	514	5.3%	5,672	6.0%	13,161	5.8%
Age 10 to 14 Years	497	5.1%	6,066	6.4%	13,526	6.0%
Age 15 to 19 Years	478	4.9%	5,935	6.2%	13,761	6.1%
Age 20 to 24 Years	548	5.6%	5,977	6.3%	14,996	6.6%
Age 25 to 29 Years	630	6.5%	5,897	6.2%	13,911	6.1%
Age 30 to 34 Years	586	6.0%	5,734	6.0%	14,255	6.3%
Age 35 to 39 Years	539	5.6%	5,452	5.7%	13,701	6.0%
Age 40 to 44 Years	512	5.3%	5,502	5.8%	13,577	6.0%
Age 45 to 49 Years	490	5.1%	5,481	5.8%	12,980	5.7%
Age 50 to 54 Years	583	6.0%	6,265	6.6%	14,698	6.5%
Age 55 to 59 Years	615	6.3%	6,221	6.5%	15,019	6.6%
Age 60 to 64 Years	738	7.6%	6,587	6.9%	15,835	7.0%
Age 65 to 74 Years	1,274	13.1%	11,214	11.8%	26,572	11.7%
Age 75 to 84 Years	831	8.6%	5,845	6.1%	13,434	5.9%
Age 85 Years or Over	340	3.5%	2,213	2.3%	5,056	2.2%
Median Age	44.5		40.8		40.8	

#### Gender Age Distribution (2023)

Female Population	5,111	52.7%	49,187	51.6%	116,513	51.4%
Age 0 to 19 Years	965	18.9%	11,257	22.9%	25,620	22.0%
Age 20 to 64 Years	2,706	52.9%	27,082	55.1%	65,506	56.2%
Age 65 Years or Over	1,440	28.2%	10,848	22.1%	25,387	21.8%
Female Median Age	47.0		42.0		42.3	
Male Population	4,583	47.3%	46,111	48.4%	110,180	48.6%
Age 0 to 19 Years	1,044	22.8%	11,652	25.3%	27,038	24.5%
Age 20 to 64 Years	2,534	55.3%	26,034	56.5%	63,467	57.6%
Age 65 Years or Over	1,005	21.9%	8,425	18.3%	19,675	17.9%
Male Median Age	41.8		39.5		39.3	



## Expanded Profile

2010-2020 Census, 2023 Estimates with 2028 Projections  
Calculated using Weighted Block Centroid from Block Groups

Lat/Lon: 41.4302/-82.2015

### 4415 N Leavitt Rd

Lorain, OH 44053

1 mi radius

5 mi radius

10 mi radius

#### Household Income Distribution (2023)

HH Income \$200,000 or More	66	1.5%	1,816	4.7%	6,371	6.8%
HH Income \$150,000 to \$199,999	228	5.2%	2,154	5.6%	6,699	7.1%
HH Income \$100,000 to \$149,999	642	14.6%	5,039	13.0%	14,395	15.4%
HH Income \$75,000 to \$99,999	967	21.9%	5,422	14.0%	13,117	14.0%
HH Income \$50,000 to \$74,999	679	15.4%	6,087	15.7%	15,142	16.2%
HH Income \$35,000 to \$49,999	503	11.4%	5,273	13.6%	11,539	12.3%
HH Income \$25,000 to \$34,999	401	9.1%	3,794	9.8%	8,360	8.9%
HH Income \$15,000 to \$24,999	388	8.8%	3,392	8.8%	7,204	7.7%
HH Income Under \$15,000	540	12.2%	5,700	14.7%	10,897	11.6%
HH Income \$35,000 or More	3,085	69.9%	25,791	66.7%	67,263	71.8%
HH Income \$75,000 or More	1,903	43.1%	14,431	37.3%	40,582	43.3%

#### Housing (2023)

Total Housing Units	4,591		42,020		101,084	
Housing Units Occupied	4,414	96.1%	38,676	92.0%	93,724	92.7%
Housing Units Owner-Occupied	3,010	68.2%	26,520	68.6%	65,433	69.8%
Housing Units, Renter-Occupied	1,404	31.8%	12,156	31.4%	28,291	30.2%
Housing Units, Vacant	177	4.0%	3,344	8.6%	7,360	7.9%

#### Marital Status (2023)

Never Married	2,814	34.5%	30,212	38.6%	66,499	35.4%
Currently Married	3,341	40.9%	29,447	37.6%	79,213	42.2%
Separated	440	5.4%	2,932	3.7%	5,831	3.1%
Widowed	448	5.5%	5,589	7.1%	12,540	6.7%
Divorced	1,120	13.7%	10,144	13.0%	23,713	12.6%

#### Household Type (2023)

Population Family	7,649	78.9%	77,284	81.1%	180,678	79.7%
Population Non-Family	1,975	20.4%	17,093	17.9%	40,830	18.0%
Population Group Quarters	70	0.7%	921	1.0%	5,185	2.3%
Family Households	2,643	59.9%	24,641	63.7%	59,652	63.6%
Non-Family Households	1,771	40.1%	14,035	36.3%	34,072	36.4%
Married Couple with Children	518	15.5%	4,315	14.7%	14,018	17.7%
Average Family Household Size	2.9		3.1		3.0	

#### Household Size (2023)

1 Person Households	1,615	36.6%	12,287	31.8%	29,483	31.5%
2 Person Households	1,490	33.7%	12,919	33.4%	33,559	35.8%
3 Person Households	604	13.7%	5,732	14.8%	13,000	13.9%
4 Person Households	459	10.4%	4,347	11.2%	10,369	11.1%
5 Person Households	183	4.1%	2,210	5.7%	4,890	5.2%
6 or More Person Households	64	1.5%	1,181	3.1%	2,422	2.6%

#### Household Vehicles (2023)

Households with 0 Vehicles Available	350	7.9%	2,953	7.6%	6,377	6.8%
Households with 1 Vehicles Available	1,555	35.2%	15,076	39.0%	34,738	37.1%
Households with 2 or More Vehicles Available	2,509	56.9%	20,647	53.4%	52,609	56.1%
Total Vehicles Available	7,596		66,417		163,504	
Average Vehicles Per Household	1.7		1.7		1.7	



## Expanded Profile

2010-2020 Census, 2023 Estimates with 2028 Projections  
Calculated using Weighted Block Centroid from Block Groups

Lat/Lon: 41.4302/-82.2015

### 4415 N Leavitt Rd

Lorain, OH 44053

1 mi radius

5 mi radius

10 mi radius

#### Labor Force (2023)

Estimated Labor Population Age 16 Years or Over	8,060		77,022		184,947	
Estimated Civilian Employed	4,717	58.5%	43,382	56.3%	108,945	58.9%
Estimated Civilian Unemployed	98	1.2%	2,216	2.9%	4,620	2.5%
Estimated in Armed Forces	-	-	32	-	89	-
Estimated Not in Labor Force	3,245	40.3%	31,391	40.8%	71,293	38.5%
Unemployment Rate	1.2%		2.9%		2.5%	

#### Occupation (2023)

Occupation: Population Age 16 Years or Over	4,717		43,382		108,941	
Management, Business, Financial Operations	546	11.6%	4,402	10.1%	13,974	12.8%
Professional, Related	856	18.1%	7,740	17.8%	23,120	21.2%
Service	869	18.4%	8,613	19.9%	17,839	16.4%
Sales, Office	1,207	25.6%	10,955	25.3%	26,584	24.4%
Farming, Fishing, Forestry	4	-	94	0.2%	212	0.2%
Construct, Extraction, Maintenance	363	7.7%	3,241	7.5%	8,593	7.9%
Production, Transport Material Moving	873	18.5%	8,336	19.2%	18,620	17.1%
White Collar Workers	2,608	55.3%	23,098	53.2%	63,678	58.5%
Blue Collar Workers	2,109	44.7%	20,285	46.8%	45,263	41.5%

#### Consumer Expenditure (2023)

Total Household Expenditure	\$254.24 M		\$2.31 B		\$6.23 B	
Total Non-Retail Expenditure	\$133.82 M	52.6%	\$1.22 B	52.8%	\$3.29 B	52.8%
Total Retail Expenditure	\$120.42 M	47.4%	\$1.09 B	47.2%	\$2.94 B	47.2%
Apparel	\$8.8 M	3.5%	\$80.61 M	3.5%	\$218.78 M	3.5%
Contributions	\$8.04 M	3.2%	\$74.42 M	3.2%	\$205.05 M	3.3%
Education	\$6.89 M	2.7%	\$66.93 M	2.9%	\$186.87 M	3.0%
Entertainment	\$14.2 M	5.6%	\$129.34 M	5.6%	\$352.68 M	5.7%
Food and Beverages	\$37.79 M	14.9%	\$341.37 M	14.8%	\$916.02 M	14.7%
Furnishings and Equipment	\$8.85 M	3.5%	\$80.4 M	3.5%	\$219.06 M	3.5%
Gifts	\$5.89 M	2.3%	\$55.18 M	2.4%	\$152.64 M	2.5%
Health Care	\$22.21 M	8.7%	\$198.26 M	8.6%	\$529.77 M	8.5%
Household Operations	\$9.88 M	3.9%	\$90.41 M	3.9%	\$245.47 M	3.9%
Miscellaneous Expenses	\$4.81 M	1.9%	\$43.69 M	1.9%	\$118.23 M	1.9%
Personal Care	\$3.43 M	1.3%	\$30.98 M	1.3%	\$83.65 M	1.3%
Personal Insurance	\$1.73 M	0.7%	\$15.96 M	0.7%	\$44.09 M	0.7%
Reading	\$557.85 K	0.2%	\$5.06 M	0.2%	\$13.69 M	0.2%
Shelter	\$53.59 M	21.1%	\$486.81 M	21.1%	\$1.31 B	21.1%
Tobacco	\$1.65 M	0.6%	\$14.64 M	0.6%	\$37.64 M	0.6%
Transportation	\$46.52 M	18.3%	\$418.88 M	18.2%	\$1.13 B	18.2%
Utilities	\$19.4 M	7.6%	\$173.92 M	7.5%	\$460.05 M	7.4%

#### Educational Attainment (2023)

Adult Population Age 25 Years or Over	7,137		66,411		159,039	
Elementary (Grade Level 0 to 8)	230	3.2%	2,031	3.1%	3,333	2.1%
Some High School (Grade Level 9 to 11)	507	7.1%	5,789	8.7%	11,472	7.2%
High School Graduate	2,349	32.9%	23,143	34.8%	50,720	31.9%
Some College	1,804	25.3%	16,149	24.3%	35,395	22.3%
Associate Degree Only	996	14.0%	7,127	10.7%	17,630	11.1%
Bachelor Degree Only	903	12.6%	8,296	12.5%	25,612	16.1%
Graduate Degree	349	4.9%	3,875	5.8%	14,877	9.4%



## Expanded Profile

2010-2020 Census, 2023 Estimates with 2028 Projections  
Calculated using Weighted Block Centroid from Block Groups

Lat/Lon: 41.4302/-82.2015

### 4415 N Leavitt Rd

Lorain, OH 44053

1 mi radius

5 mi radius

10 mi radius

#### Units In Structure (2023)

1 Detached Unit	3,169	78.8%	28,938	78.0%	69,556	81.4%
1 Attached Unit	134	3.3%	1,471	4.0%	4,678	5.5%
2 to 4 Units	283	7.0%	2,337	6.3%	5,844	6.8%
5 to 9 Units	287	7.1%	1,587	4.3%	3,968	4.6%
10 to 19 Units	245	6.1%	1,784	4.8%	4,095	4.8%
20 to 49 Units	90	2.2%	772	2.1%	1,542	1.8%
50 or More Units	162	4.0%	1,008	2.7%	2,456	2.9%
Mobile Home or Trailer	44	1.1%	773	2.1%	1,571	1.8%
Other Structure	-	-	5	-	13	-

#### Homes Built By Year (2023)

Homes Built 2010 or later	547	13.6%	2,885	7.8%	8,803	10.3%
Homes Built 2000 to 2009	332	8.3%	3,188	8.6%	10,787	12.6%
Homes Built 1990 to 1999	319	7.9%	2,816	7.6%	8,334	9.8%
Homes Built 1980 to 1989	226	5.6%	1,917	5.2%	4,726	5.5%
Homes Built 1970 to 1979	1,098	27.3%	6,029	16.3%	14,373	16.8%
Homes Built 1960 to 1969	1,130	28.1%	6,835	18.4%	15,236	17.8%
Homes Built 1950 to 1959	524	13.0%	6,152	16.6%	13,260	15.5%
Homes Built Before 1949	238	5.9%	8,854	23.9%	18,204	21.3%

#### Home Values (2023)

Home Values \$1,000,000 or More	7	0.2%	42	0.2%	189	0.3%
Home Values \$500,000 to \$999,999	30	1.0%	477	1.8%	1,423	2.2%
Home Values \$400,000 to \$499,999	54	1.8%	890	3.4%	2,797	4.3%
Home Values \$300,000 to \$399,999	208	6.9%	2,681	10.1%	7,680	11.7%
Home Values \$200,000 to \$299,999	616	20.5%	5,178	19.5%	14,522	22.2%
Home Values \$150,000 to \$199,999	729	24.2%	4,747	17.9%	11,884	18.2%
Home Values \$100,000 to \$149,999	792	26.3%	5,132	19.3%	12,124	18.5%
Home Values \$70,000 to \$99,999	393	13.0%	3,580	13.5%	7,630	11.7%
Home Values \$50,000 to \$69,999	59	2.0%	1,820	6.9%	3,432	5.2%
Home Values \$25,000 to \$49,999	68	2.3%	1,068	4.0%	1,760	2.7%
Home Values Under \$25,000	53	1.8%	906	3.4%	1,991	3.0%
Owner-Occupied Median Home Value	\$156,835		\$154,261		\$174,437	
Renter-Occupied Median Rent	\$674		\$675		\$712	

#### Transportation To Work (2023)

Drive to Work Alone	3,895	82.6%	34,517	79.6%	86,818	79.7%
Drive to Work in Carpool	475	10.1%	5,044	11.6%	10,460	9.6%
Travel to Work by Public Transportation	5	0.1%	236	0.5%	645	0.6%
Drive to Work on Motorcycle	-	-	15	-	44	-
Walk or Bicycle to Work	31	0.7%	488	1.1%	2,351	2.2%
Other Means	146	3.1%	877	2.0%	1,269	1.2%
Work at Home	165	3.5%	2,204	5.1%	7,354	6.7%

#### Travel Time (2023)

Travel to Work in 14 Minutes or Less	1,195	25.3%	10,705	24.7%	26,531	24.4%
Travel to Work in 15 to 29 Minutes	1,928	40.9%	16,389	37.8%	39,136	35.9%
Travel to Work in 30 to 59 Minutes	1,214	25.7%	12,158	28.0%	31,447	28.9%
Travel to Work in 60 Minutes or More	216	4.6%	1,925	4.4%	4,473	4.1%
Average Minutes Travel to Work	21.9		21.8		22.2	