

**8739 Niagara Falls Blvd \$7/sq. ft. NNN**  
Niagara Falls, NY 14304

\*NNN includes but not limited to Real Estate Taxes, Insurance, and CAM (such as parking lot maintenance, snow removal, lawn care, etc.)

RETAIL SPACE FOR LEASE

### Aerial - Site View



**13,088 sq. ft. available adjacent to Dollar General**

**Large ample parking lot**

**Easy ingress/egress onto Niagara Falls Boulevard**

### Population Density Shading



### Demographic Data

	1 mi radius	3 mi radius	5 mi radius
Population (2019)	10,466	32,203	85,514
Households (2019)	5,069	15,105	38,984
Median household income (2019)	\$53,050	\$59,126	\$54,178
Total Employees	6,074	16,835	38,429
Total Establishments	487	1,418	3,217

### Population Density

By Blockgroups

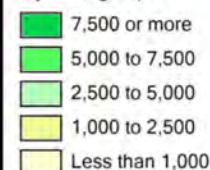

**COCCA DEVELOPMENT, LTD**

100 DEBARTOLO PLACE SUITE 400 BOARDMAN, OHIO 44512  
(330) 729-1010

[WWW.COCCADEVELOPMENT.COM](http://WWW.COCCADEVELOPMENT.COM)

This map was produced using data from private and government sources deemed to be reliable. The information herein is provided without representation or warranty.

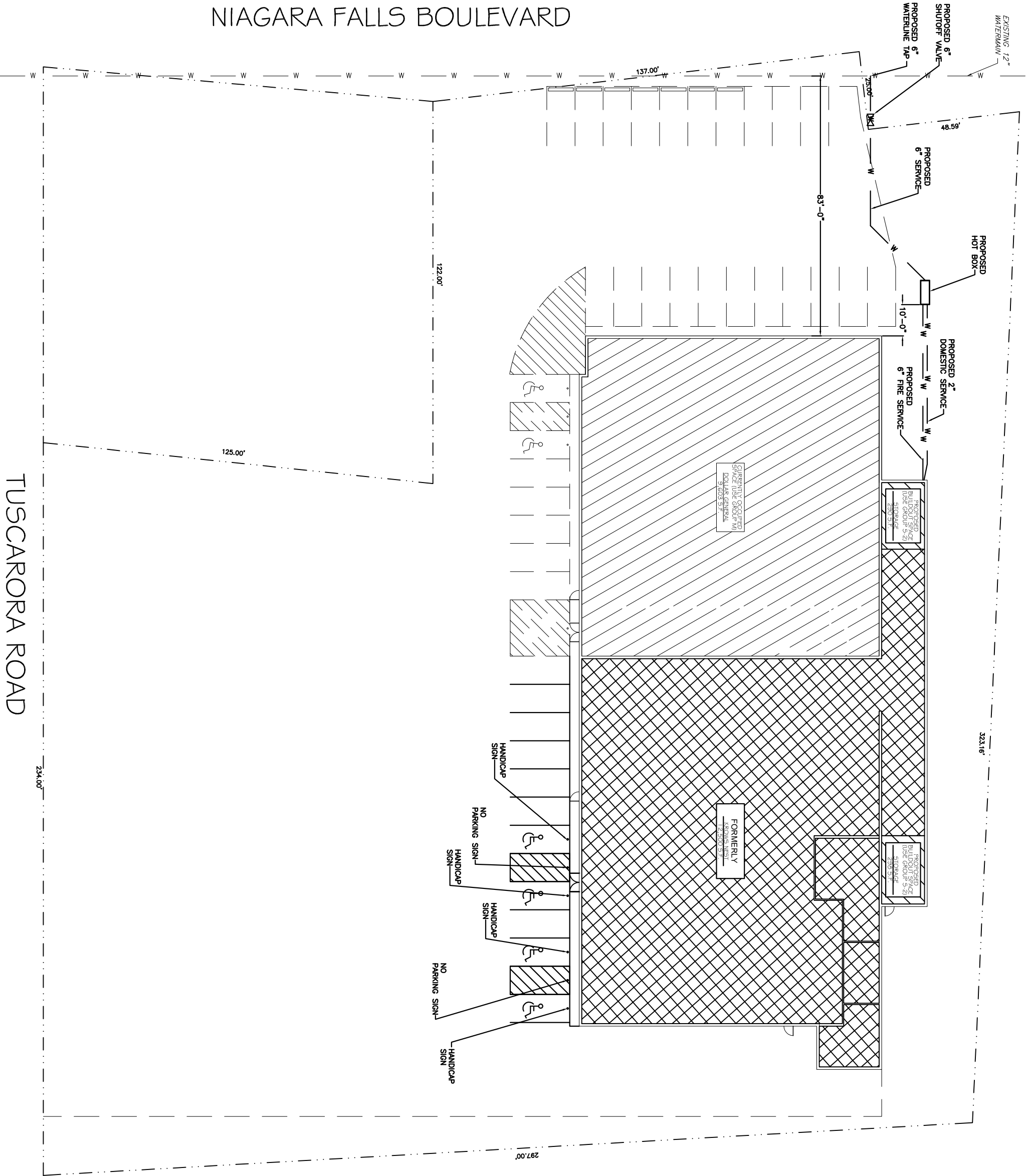

**8739 Niagara Falls Blvd**  
**Niagara Falls, NY 14304**



8739 Niagara Falls Blvd  
Niagara Falls, NY 14304

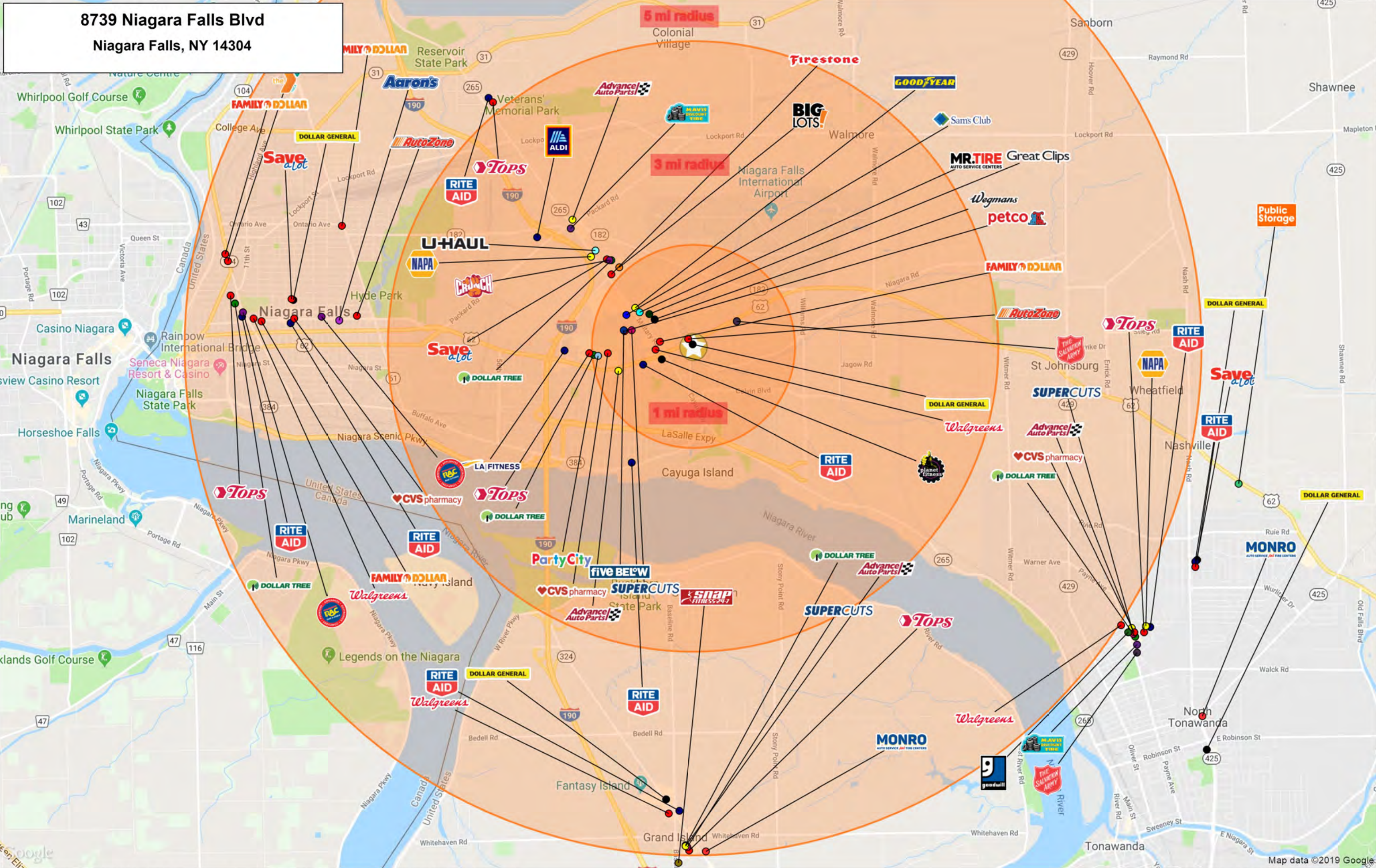

# GRAPHIC PROFILE

2000-2010 Census, 2019 Estimates with 2024 Projections

Calculated using Weighted Block Centroid from Block Groups

Lat/Lon: 43.0912/-78.9623

RGRAP3

## 8739 Niagara Falls Blvd

Niagara Falls, NY 14304

1 mi radius

3 mi radius

5 mi radius

### Population

Estimated Population (2019)	10,581	32,203	85,465
Projected Population (2024)	10,325	31,481	86,355
Census Population (2010)	11,245	33,651	88,018
Census Population (2000)	12,051	34,259	91,703
Projected Annual Growth (2019-2024)	-256 -0.5%	-722 -0.4%	890 0.2%
Historical Annual Growth (2010-2019)	-664 -0.7%	-1,448 -0.5%	-2,553 -0.3%
Historical Annual Growth (2000-2010)	-806 -0.7%	-608 -0.2%	-3,685 -0.4%
Estimated Population Density (2019)	3,370 <i>psm</i>	1,140 <i>psm</i>	1,089 <i>psm</i>
Trade Area Size	3.1 <i>sq mi</i>	28.3 <i>sq mi</i>	78.5 <i>sq mi</i>

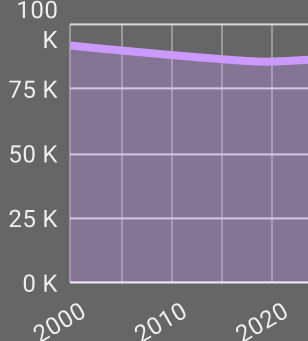
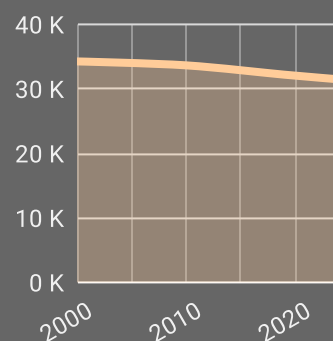
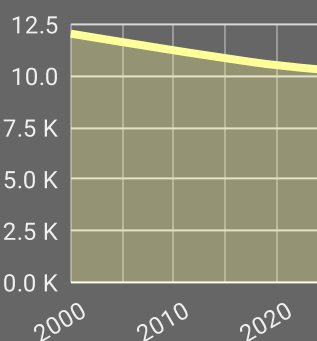

### Race and Ethnicity (2019)

Not Hispanic or Latino Population	10,325	97.6%	31,344	97.3%	82,500	96.5%
White	9,230	89.4%	27,750	88.5%	65,172	79.0%
Black or African American	444	4.3%	1,669	5.3%	11,612	14.1%
American Indian or Alaska Native	127	1.2%	349	1.1%	1,087	1.3%
Asian	208	2.0%	713	2.3%	1,765	2.1%
Hawaiian or Pacific Islander	1	-	4	-	9	-
Other Race	13	0.1%	57	0.2%	105	0.1%
Two or More Races	302	2.9%	803	2.6%	2,750	3.3%
Hispanic or Latino Population	256	2.4%	859	2.7%	2,965	3.5%
White	157	61.1%	560	65.2%	1,592	53.7%
Black or African American	10	4.1%	56	6.6%	314	10.6%
American Indian or Alaska Native	9	3.4%	15	1.8%	62	2.1%
Asian	2	0.8%	3	0.3%	21	0.7%
Hispanic Hawaiian or Pacific Islander	-	-	-	-	5	0.2%
Other Race	50	19.4%	153	17.9%	599	20.2%
Two or More Races	29	11.2%	71	8.2%	372	12.5%

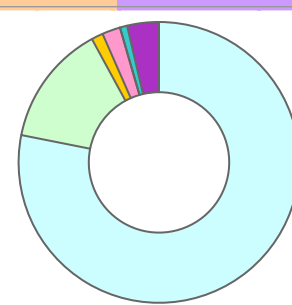
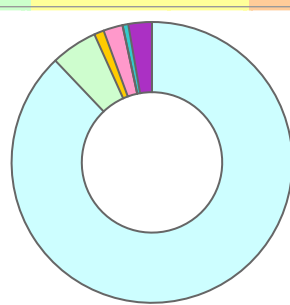
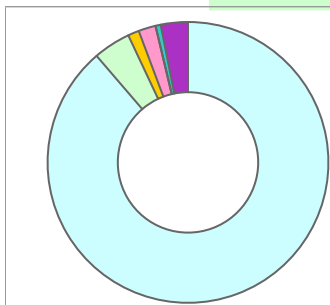

White Black or African American American Indian or Alaska Native Asian Hawaiian or Pacific Islander Other Race 2+ Races

# GRAPHIC PROFILE

2000-2010 Census, 2019 Estimates with 2024 Projections

Calculated using Weighted Block Centroid from Block Groups

Lat/Lon: 43.0912/-78.9623

RGRAP3

8739 Niagara Falls Blvd

Niagara Falls, NY 14304

1 mi radius

3 mi radius

5 mi radius

## Age Distribution (2019)

Age Under 5 Years	483	4.6%	1,490	4.6%	4,487	5.3%
Age 5 to 9 Years	474	4.5%	1,586	4.9%	4,649	5.4%
Age 10 to 14 Years	571	5.4%	1,704	5.3%	4,644	5.4%
Age 15 to 19 Years	516	4.9%	1,742	5.4%	5,407	6.3%
Age 20 to 24 Years	594	5.6%	1,843	5.7%	5,742	6.7%
Age 25 to 29 Years	708	6.7%	2,166	6.7%	5,963	7.0%
Age 30 to 34 Years	705	6.7%	2,054	6.4%	5,330	6.2%
Age 35 to 39 Years	678	6.4%	1,930	6.0%	4,933	5.8%
Age 40 to 44 Years	550	5.2%	1,687	5.2%	4,395	5.1%
Age 45 to 49 Years	582	5.5%	1,892	5.9%	5,030	5.9%
Age 50 to 54 Years	676	6.4%	2,182	6.8%	5,693	6.7%
Age 55 to 59 Years	884	8.4%	2,700	8.4%	6,583	7.7%
Age 60 to 64 Years	828	7.8%	2,521	7.8%	6,162	7.2%
Age 65 to 69 Years	714	6.7%	2,049	6.4%	5,050	5.9%
Age 70 to 74 Years	616	5.8%	1,710	5.3%	4,011	4.7%
Age 75 to 79 Years	427	4.0%	1,196	3.7%	2,848	3.3%
Age 80 to 84 Years	274	2.6%	833	2.6%	2,038	2.4%
Age 85 Years or Over	300	2.8%	918	2.9%	2,502	2.9%
Median Age	44.2		43.6		41.1	

## Generation (2019)

iGeneration (Age Under 15 Years)	1,527	14.4%	4,779	14.8%	13,780	16.1%
Generation 9/11 Millennials (Age 15 to 34 Years)	2,524	23.9%	7,805	24.2%	22,442	26.3%
Gen Xers (Age 35 to 49 Years)	1,810	17.1%	5,509	17.1%	14,358	16.8%
Baby Boomers (Age 50 to 74 Years)	3,719	35.2%	11,162	34.7%	27,498	32.2%
Silent Generation (Age 75 to 84 Years)	700	6.6%	2,029	6.3%	4,886	5.7%
G.I. Generation (Age 85 Years or Over)	300	2.8%	918	2.9%	2,502	2.9%

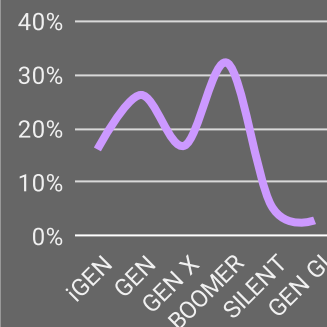
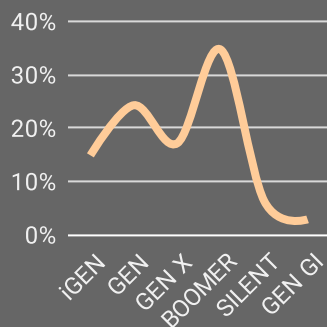
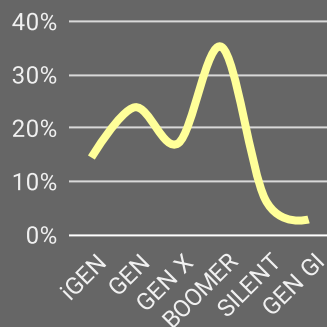

This report was produced using data from private and government sources deemed to be reliable. The information herein is provided without representation or warranty.

# GRAPHIC PROFILE

2000-2010 Census, 2019 Estimates with 2024 Projections

Calculated using Weighted Block Centroid from Block Groups

Lat/Lon: 43.0912/-78.9623

RGRAP3

8739 Niagara Falls Blvd

Niagara Falls, NY 14304

1 mi radius

3 mi radius

5 mi radius

## Household Type (2019)

		1 mi radius	3 mi radius	5 mi radius
Total Households		5,128	15,105	38,963
Family Households		2,828 55.1%	8,594 56.9%	21,773 55.9%
Family Households with Children		1,110 39.3%	3,500 40.7%	9,575 44.0%
Family Households No Children		1,718 60.7%	5,094 59.3%	12,198 56.0%
Non-Family Households		2,300 44.9%	6,511 43.1%	17,190 44.1%
Non-Family Households with Children		11 0.5%	47 0.7%	116 0.7%
Non-Family Households No Children		2,289 99.5%	6,464 99.3%	17,074 99.3%

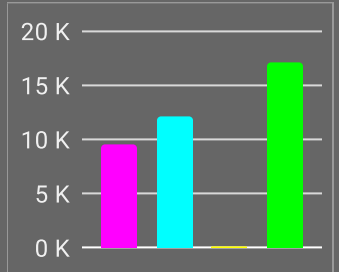
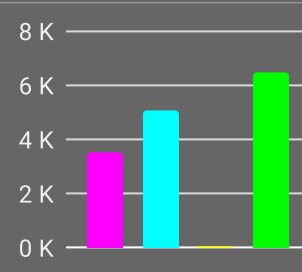
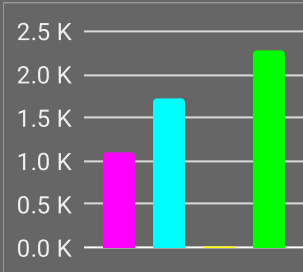

## Education Attainment (2019)

		1 mi radius	3 mi radius	5 mi radius
Elementary or Some High School		747 9.4%	2,023 8.5%	5,967 9.9%
High School Graduate		3,140 39.5%	8,986 37.7%	21,634 35.7%
Some College or Associate Degree		2,736 34.4%	7,716 32.4%	19,228 31.8%
Bachelor or Graduate Degree		1,320 16.6%	5,114 21.5%	13,708 22.6%

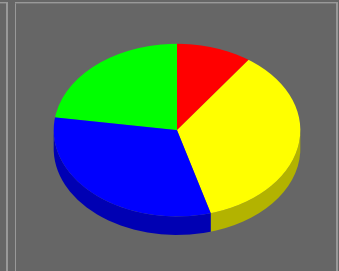
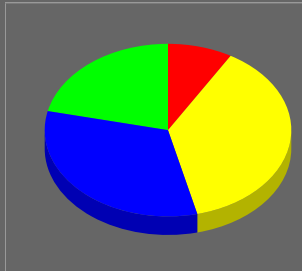
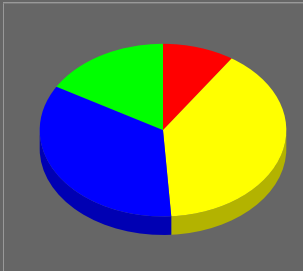

## Household Income (2019)

		1 mi radius	3 mi radius	5 mi radius
Estimated Average Household Income		\$62,738	\$64,976	\$59,920
Estimated Median Household Income		\$53,002	\$59,126	\$54,168
HH Income Under \$10,000		243 4.7%	757 5.0%	3,180 8.2%
HH Income \$10,000 to \$34,999		1,502 29.3%	3,966 26.3%	11,177 28.7%
HH Income \$35,000 to \$49,999		731 14.3%	2,144 14.2%	5,162 13.2%
HH Income \$50,000 to \$74,999		1,059 20.6%	2,855 18.9%	7,101 18.2%
HH Income \$75,000 to \$99,999		695 13.5%	2,133 14.1%	4,775 12.3%
HH Income \$100,000 to \$149,999		627 12.2%	2,183 14.5%	4,744 12.2%
HH Income \$150,000 or More		272 5.3%	1,066 7.1%	2,826 7.3%

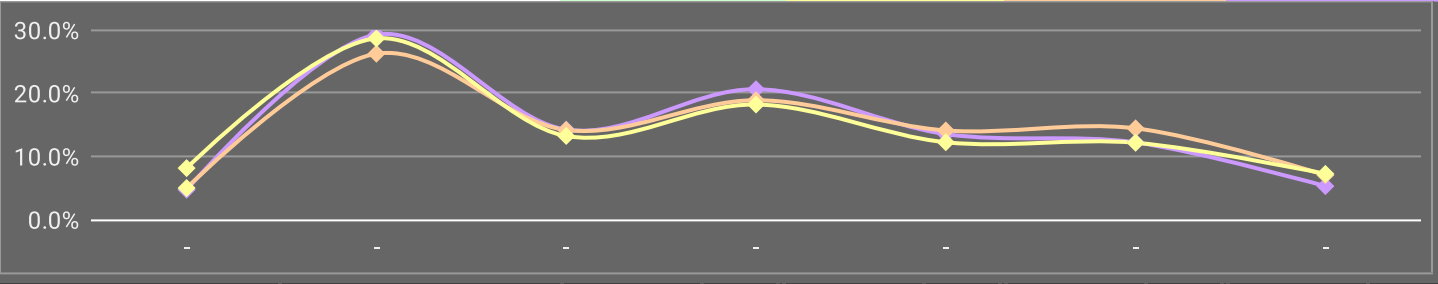

# EXPANDED PROFILE

2000-2010 Census, 2019 Estimates with 2024 Projections

Calculated using Weighted Block Centroid from Block Groups

Lat/Lon: 43.0912/-78.9623

RF5

## 8739 Niagara Falls Blvd

## Niagara Falls, NY 14304

### Population

	1 mi radius		3 mi radius		5 mi radius	
Estimated Population (2019)	10,581		32,203		85,465	
Projected Population (2024)	10,325		31,481		86,355	
Census Population (2010)	11,245		33,651		88,018	
Census Population (2000)	12,051		34,259		91,703	
Projected Annual Growth (2019 to 2024)	-256	-0.5%	-722	-0.4%	890	0.2%
Historical Annual Growth (2010 to 2019)	-664	-0.7%	-1,448	-0.5%	-2,553	-0.3%
Historical Annual Growth (2000 to 2010)	-806	-0.7%	-608	-0.2%	-3,685	-0.4%
Estimated Population Density (2019)	3,370	psm	1,140	psm	1,089	psm
Trade Area Size	3.1	sq mi	28.3	sq mi	78.5	sq mi

### Households

Estimated Households (2019)	5,128		15,105		38,963	
Projected Households (2024)	5,109		15,037		40,236	
Census Households (2010)	5,092		14,795		37,661	
Census Households (2000)	5,151		14,104		37,665	
Estimated Households with Children (2019)	1,121	21.9%	3,547	23.5%	9,691	24.9%
Estimated Average Household Size (2019)	2.06		2.12		2.14	

### Average Household Income

Estimated Average Household Income (2019)	\$62,738		\$64,976		\$59,920	
Projected Average Household Income (2024)	\$74,746		\$76,556		\$67,160	
Estimated Average Family Income (2019)	\$79,962		\$85,404		\$80,098	

### Median Household Income

Estimated Median Household Income (2019)	\$53,002		\$59,126		\$54,168	
Projected Median Household Income (2024)	\$62,295		\$69,385		\$62,525	
Estimated Median Family Income (2019)	\$68,984		\$78,189		\$72,407	

### Per Capita Income

Estimated Per Capita Income (2019)	\$30,411		\$30,510		\$27,450	
Projected Per Capita Income (2024)	\$36,992		\$36,601		\$31,424	
Estimated Per Capita Income 5 Year Growth	\$6,580	21.6%	\$6,091	20.0%	\$3,974	14.5%
Estimated Average Household Net Worth (2019)	\$401,895		\$489,466		\$488,181	

### Daytime Demos (2019)

Total Businesses	550		1,418		3,214	
Total Employees	6,470		16,835		38,422	
Company Headquarter Businesses	-	-	3	0.2%	15	0.5%
Company Headquarter Employees	-	-	205	1.2%	2,010	5.2%
Employee Population per Business	11.8		11.9		12.0	
Residential Population per Business	19.2		22.7		26.6	

This report was produced using data from private and government sources deemed to be reliable. The information herein is provided without representation or warranty.

# EXPANDED PROFILE

2000-2010 Census, 2019 Estimates with 2024 Projections

Calculated using Weighted Block Centroid from Block Groups

Lat/Lon: 43.0912/-78.9623

RF5

## 8739 Niagara Falls Blvd

## Niagara Falls, NY 14304

1 mi radius

3 mi radius

5 mi radius

### Race & Ethnicity

White (2019)	9,387	88.7%	28,310	87.9%	66,764	78.1%
Black or African American (2019)	454	4.3%	1,725	5.4%	11,926	14.0%
American Indian or Alaska Native (2019)	136	1.3%	364	1.1%	1,149	1.3%
Asian (2019)	210	2.0%	716	2.2%	1,785	2.1%
Hawaiian or Pacific Islander (2019)	1	-	4	-	14	-
Other Race (2019)	62	0.6%	210	0.7%	705	0.8%
Two or More Races (2019)	331	3.1%	873	2.7%	3,122	3.7%
Not Hispanic or Latino Population (2019)	10,325	97.6%	31,344	97.3%	82,500	96.5%
Hispanic or Latino Population (2019)	256	2.4%	859	2.7%	2,965	3.5%
Not Hispanic or Latino Population (2024)	10,051	97.4%	30,572	97.1%	83,087	96.2%
Hispanic or Latino Population (2024)	273	2.6%	909	2.9%	3,268	3.8%
Not Hispanic or Latino Population (2010)	11,065	98.4%	33,039	98.2%	85,883	97.6%
Hispanic or Latino Population (2010)	180	1.6%	612	1.8%	2,135	2.4%
Not Hispanic or Latino Population (2000)	11,930	99.0%	33,917	99.0%	90,281	98.4%
Hispanic or Latino Population (2000)	121	1.0%	343	1.0%	1,422	1.6%
Projected Hispanic Annual Growth (2019 to 2024)	17	1.4%	50	1.2%	303	2.0%
Historic Hispanic Annual Growth (2000 to 2019)	135	5.9%	516	7.9%	1,542	5.7%

### Age Distribution (2019)

Age Under 5	483	4.6%	1,490	4.6%	4,487	5.3%
Age 5 to 9 Years	474	4.5%	1,586	4.9%	4,649	5.4%
Age 10 to 14 Years	571	5.4%	1,704	5.3%	4,644	5.4%
Age 15 to 19 Years	516	4.9%	1,742	5.4%	5,407	6.3%
Age 20 to 24 Years	594	5.6%	1,843	5.7%	5,742	6.7%
Age 25 to 29 Years	708	6.7%	2,166	6.7%	5,963	7.0%
Age 30 to 34 Years	705	6.7%	2,054	6.4%	5,330	6.2%
Age 35 to 39 Years	678	6.4%	1,930	6.0%	4,933	5.8%
Age 40 to 44 Years	550	5.2%	1,687	5.2%	4,395	5.1%
Age 45 to 49 Years	582	5.5%	1,892	5.9%	5,030	5.9%
Age 50 to 54 Years	676	6.4%	2,182	6.8%	5,693	6.7%
Age 55 to 59 Years	884	8.4%	2,700	8.4%	6,583	7.7%
Age 60 to 64 Years	828	7.8%	2,521	7.8%	6,162	7.2%
Age 65 to 74 Years	1,330	12.6%	3,759	11.7%	9,060	10.6%
Age 75 to 84 Years	700	6.6%	2,029	6.3%	4,886	5.7%
Age 85 Years or Over	300	2.8%	918	2.9%	2,502	2.9%
Median Age	44.2		43.6		41.1	

### Gender Age Distribution (2019)

Female Population	5,419	51.2%	16,577	51.5%	44,240	51.8%
Age 0 to 19 Years	993	18.3%	3,143	19.0%	9,440	21.3%
Age 20 to 64 Years	3,115	57.5%	9,599	57.9%	25,339	57.3%
Age 65 Years or Over	1,310	24.2%	3,834	23.1%	9,461	21.4%
Female Median Age	46.2		45.4		42.5	
Male Population	5,162	48.8%	15,626	48.5%	41,225	48.2%
Age 0 to 19 Years	1,050	20.3%	3,378	21.6%	9,747	23.6%
Age 20 to 64 Years	3,092	59.9%	9,376	60.0%	24,491	59.4%
Age 65 Years or Over	1,021	19.8%	2,871	18.4%	6,986	16.9%
Male Median Age	42.1		41.8		39.7	

This report was produced using data from private and government sources deemed to be reliable. The information herein is provided without representation or warranty.

# EXPANDED PROFILE

2000-2010 Census, 2019 Estimates with 2024 Projections

Calculated using Weighted Block Centroid from Block Groups

Lat/Lon: 43.0912/-78.9623

RF5

## 8739 Niagara Falls Blvd

## Niagara Falls, NY 14304

1 mi radius

3 mi radius

5 mi radius

### Household Income Distribution (2019)

HH Income \$200,000 or More	32	0.6%	266	1.8%	883	2.3%
HH Income \$150,000 to \$199,999	240	4.7%	800	5.3%	1,943	5.0%
HH Income \$100,000 to \$149,999	627	12.2%	2,183	14.5%	4,744	12.2%
HH Income \$75,000 to \$99,999	695	13.5%	2,133	14.1%	4,775	12.3%
HH Income \$50,000 to \$74,999	1,059	20.6%	2,855	18.9%	7,101	18.2%
HH Income \$35,000 to \$49,999	731	14.3%	2,144	14.2%	5,162	13.2%
HH Income \$25,000 to \$34,999	649	12.7%	1,606	10.6%	4,147	10.6%
HH Income \$15,000 to \$24,999	592	11.6%	1,753	11.6%	4,777	12.3%
HH Income Under \$15,000	503	9.8%	1,364	9.0%	5,433	13.9%
HH Income \$35,000 or More	3,383	66.0%	10,381	68.7%	24,607	63.2%
HH Income \$75,000 or More	1,594	31.1%	5,382	35.6%	12,345	31.7%

### Housing (2019)

Total Housing Units	5,363		15,889		42,556	
Housing Units Occupied	5,128	95.6%	15,105	95.1%	38,963	91.6%
Housing Units Owner-Occupied	3,873	75.5%	10,752	71.2%	24,372	62.5%
Housing Units, Renter-Occupied	1,255	24.5%	4,353	28.8%	14,592	37.5%
Housing Units, Vacant	235	4.6%	784	5.2%	3,593	9.2%

### Marital Status (2019)

Never Married	3,063	33.8%	8,741	31.9%	26,126	36.4%
Currently Married	3,822	42.2%	12,164	44.4%	29,564	41.2%
Separated	406	4.5%	1,270	4.6%	3,287	4.6%
Widowed	759	8.4%	2,064	7.5%	5,059	7.1%
Divorced	1,004	11.1%	3,185	11.6%	7,649	10.7%

### Household Type (2019)

Population Family	7,965	75.3%	24,559	76.3%	63,729	74.6%
Population Non-Family	2,612	24.7%	7,486	23.2%	19,782	23.1%
Population Group Quarters	4	-	158	0.5%	1,955	2.3%
Family Households	2,828	55.1%	8,594	56.9%	21,773	55.9%
Non-Family Households	2,300	44.9%	6,511	43.1%	17,190	44.1%
Married Couple with Children	646	16.9%	2,068	17.0%	4,979	16.8%
Average Family Household Size	2.8		2.9		2.9	

### Household Size (2019)

1 Person Households	2,022	39.4%	5,683	37.6%	14,976	38.4%
2 Person Households	1,742	34.0%	5,133	34.0%	12,632	32.4%
3 Person Households	680	13.3%	2,004	13.3%	5,151	13.2%
4 Person Households	423	8.3%	1,465	9.7%	3,799	9.7%
5 Person Households	183	3.6%	566	3.8%	1,610	4.1%
6 or More Person Households	78	1.5%	253	1.7%	795	2.0%

### Household Vehicles (2019)

Households with 0 Vehicles Available	586	11.4%	1,409	9.3%	5,733	14.7%
Households with 1 Vehicles Available	1,956	38.1%	5,883	38.9%	15,323	39.3%
Households with 2 or More Vehicles Available	2,586	50.4%	7,813	51.7%	17,908	46.0%
Total Vehicles Available	7,959		24,357		57,652	
Average Vehicles Per Household	1.6		1.6		1.5	

This report was produced using data from private and government sources deemed to be reliable. The information herein is provided without representation or warranty.

# EXPANDED PROFILE

2000-2010 Census, 2019 Estimates with 2024 Projections

Calculated using Weighted Block Centroid from Block Groups

Lat/Lon: 43.0912/-78.9623

RF5

## 8739 Niagara Falls Blvd

## Niagara Falls, NY 14304

1 mi radius

3 mi radius

5 mi radius

### Labor Force (2019)

Estimated Labor Population Age 16 Years or Over	8,958		27,101		70,809	
Estimated Civilian Employed	5,613	62.7%	16,618	61.3%	40,563	57.3%
Estimated Civilian Unemployed	222	2.5%	497	1.8%	1,983	2.8%
Estimated in Armed Forces	5	-	25	-	59	-
Estimated Not in Labor Force	3,118	34.8%	9,962	36.8%	28,204	39.8%
Unemployment Rate	2.5%		1.8%		2.8%	

### Occupation (2019)

Occupation: Population Age 16 Years or Over	5,613		16,618		40,563	
Management, Business, Financial Operations	535	9.5%	1,947	11.7%	4,802	11.8%
Professional, Related	1,155	20.6%	3,858	23.2%	9,016	22.2%
Service	1,009	18.0%	2,934	17.7%	7,862	19.4%
Sales, Office	1,744	31.1%	4,722	28.4%	11,411	28.1%
Farming, Fishing, Forestry	14	0.2%	27	0.2%	57	0.1%
Construct, Extraction, Maintenance	465	8.3%	1,252	7.5%	2,485	6.1%
Production, Transport Material Moving	690	12.3%	1,878	11.3%	4,930	12.2%
White Collar Workers	3,435	61.2%	10,527	63.4%	25,229	62.2%
Blue Collar Workers	2,178	38.8%	6,090	36.6%	15,334	37.8%

### Consumer Expenditure (2019)

Total Household Expenditure	\$261.55 M		\$784.52 M		\$1.91 B	
Total Non-Retail Expenditure	\$137.84 M	52.7%	\$413.43 M	52.7%	\$1.01 B	52.8%
Total Retail Expenditure	\$123.71 M	47.3%	\$371.09 M	47.3%	\$900.61 M	47.2%
Apparel	\$8.98 M	3.4%	\$27.13 M	3.5%	\$66.24 M	3.5%
Contributions	\$8.23 M	3.1%	\$24.94 M	3.2%	\$60.44 M	3.2%
Education	\$6.93 M	2.7%	\$21.52 M	2.7%	\$53.45 M	2.8%
Entertainment	\$14.49 M	5.5%	\$43.74 M	5.6%	\$106.12 M	5.6%
Food and Beverages	\$38.9 M	14.9%	\$116.37 M	14.8%	\$283.5 M	14.9%
Furnishings and Equipment	\$9.04 M	3.5%	\$27.28 M	3.5%	\$66.13 M	3.5%
Gifts	\$5.99 M	2.3%	\$18.33 M	2.3%	\$44.75 M	2.3%
Health Care	\$23.14 M	8.8%	\$68.55 M	8.7%	\$165.8 M	8.7%
Household Operations	\$10.18 M	3.9%	\$30.59 M	3.9%	\$74.33 M	3.9%
Miscellaneous Expenses	\$4.96 M	1.9%	\$14.89 M	1.9%	\$36.18 M	1.9%
Personal Care	\$3.52 M	1.3%	\$10.57 M	1.3%	\$25.67 M	1.3%
Personal Insurance	\$1.76 M	0.7%	\$5.35 M	0.7%	\$12.91 M	0.7%
Reading	\$574.97 K	0.2%	\$1.72 M	0.2%	\$4.18 M	0.2%
Shelter	\$55.14 M	21.1%	\$165.27 M	21.1%	\$404.53 M	21.2%
Tobacco	\$1.76 M	0.7%	\$5.11 M	0.7%	\$12.56 M	0.7%
Transportation	\$47.64 M	18.2%	\$143.16 M	18.2%	\$346.21 M	18.1%
Utilities	\$20.32 M	7.8%	\$60 M	7.6%	\$146.02 M	7.6%

### Educational Attainment (2019)

Adult Population Age 25 Years or Over	7,943		23,839		60,536	
Elementary (Grade Level 0 to 8)	218	2.7%	563	2.4%	1,692	2.8%
Some High School (Grade Level 9 to 11)	529	6.7%	1,460	6.1%	4,275	7.1%
High School Graduate	3,140	39.5%	8,986	37.7%	21,634	35.7%
Some College	1,657	20.9%	4,754	19.9%	11,898	19.7%
Associate Degree Only	1,079	13.6%	2,963	12.4%	7,330	12.1%
Bachelor Degree Only	808	10.2%	2,959	12.4%	8,026	13.3%
Graduate Degree	512	6.4%	2,155	9.0%	5,682	9.4%

This report was produced using data from private and government sources deemed to be reliable. The information herein is provided without representation or warranty.

# EXPANDED PROFILE

2000-2010 Census, 2019 Estimates with 2024 Projections

Calculated using Weighted Block Centroid from Block Groups

Lat/Lon: 43.0912/-78.9623

RF5

## 8739 Niagara Falls Blvd

## Niagara Falls, NY 14304

1 mi radius

3 mi radius

5 mi radius

### Units In Structure (2019)

1 Detached Unit	3,849	75.6%	11,005	74.4%	27,133	72.0%
1 Attached Unit	115	2.3%	467	3.2%	1,059	2.8%
2 to 4 Units	314	6.2%	1,180	8.0%	5,489	14.6%
5 to 9 Units	172	3.4%	651	4.4%	1,469	3.9%
10 to 19 Units	181	3.6%	529	3.6%	996	2.6%
20 to 49 Units	88	1.7%	331	2.2%	619	1.6%
50 or More Units	61	1.2%	346	2.3%	1,399	3.7%
Mobile Home or Trailer	347	6.8%	597	4.0%	799	2.1%
Other Structure	-	-	-	-	-	-

### Homes Built By Year (2019)

Homes Built 2010 or later	22	0.4%	226	1.5%	911	2.4%
Homes Built 2000 to 2009	50	1.0%	478	3.2%	1,389	3.7%
Homes Built 1990 to 1999	239	4.7%	1,229	8.3%	2,731	7.3%
Homes Built 1980 to 1989	251	4.9%	960	6.5%	1,918	5.1%
Homes Built 1970 to 1979	747	14.7%	2,107	14.2%	4,441	11.8%
Homes Built 1960 to 1969	745	14.6%	1,929	13.0%	3,928	10.4%
Homes Built 1950 to 1959	1,582	31.1%	4,003	27.1%	8,008	21.3%
Homes Built Before 1949	1,493	29.3%	4,173	28.2%	15,636	41.5%

### Home Values (2019)

Home Values \$1,000,000 or More	5	0.1%	12	0.1%	55	0.2%
Home Values \$500,000 to \$999,999	97	2.5%	276	2.6%	681	2.9%
Home Values \$400,000 to \$499,999	33	0.9%	177	1.7%	381	1.6%
Home Values \$300,000 to \$399,999	63	1.6%	268	2.5%	831	3.5%
Home Values \$200,000 to \$299,999	239	6.2%	1,637	15.5%	3,599	15.2%
Home Values \$150,000 to \$199,999	340	8.8%	1,422	13.5%	3,610	15.3%
Home Values \$100,000 to \$149,999	736	19.0%	1,838	17.4%	4,188	17.7%
Home Values \$70,000 to \$99,999	1,487	38.5%	2,835	26.9%	5,108	21.6%
Home Values \$50,000 to \$69,999	480	12.4%	1,300	12.3%	2,766	11.7%
Home Values \$25,000 to \$49,999	166	4.3%	478	4.5%	1,977	8.4%
Home Values Under \$25,000	204	5.3%	462	4.4%	966	4.1%
Owner-Occupied Median Home Value	\$93,656		\$117,357		\$119,931	
Renter-Occupied Median Rent	\$556		\$593		\$568	

### Transportation To Work (2019)

Drive to Work Alone	4,267	82.9%	13,432	85.9%	35,195	84.8%
Drive to Work in Carpool	576	11.2%	1,323	8.5%	2,787	6.7%
Travel to Work by Public Transportation	65	1.3%	176	1.1%	917	2.2%
Drive to Work on Motorcycle	-	-	1	-	13	-
Walk or Bicycle to Work	116	2.3%	205	1.3%	1,228	3.0%
Other Means	20	0.4%	224	1.4%	507	1.2%
Work at Home	104	2.0%	283	1.8%	880	2.1%

### Travel Time (2019)

Travel to Work in 14 Minutes or Less	1,986	38.6%	5,822	37.2%	13,404	32.3%
Travel to Work in 15 to 29 Minutes	2,046	39.7%	6,475	41.4%	16,242	39.1%
Travel to Work in 30 to 59 Minutes	1,238	24.0%	3,453	22.1%	8,878	21.4%
Travel to Work in 60 Minutes or More	227	4.4%	553	3.5%	1,192	2.9%
Average Minutes Travel to Work	17.9		18.2		18.7	

This report was produced using data from private and government sources deemed to be reliable. The information herein is provided without representation or warranty.