

COCCA DEVELOPMENT

RETAIL SPACE FOR LEASE **340 WEST ARMY TRAIL ROAD** BLOOMINGDALE, IL 60108



- HH Gregg located in the Bloomingdale Court Shopping Center with Wal-Mart Supercenter and next to Super Target
- Large lot with ample parking in the shopping center
- Front wall and pylon signs located at main entrances
- Easy ingress/egress to West Army Trail, Schmale Road, and North Gary Avenue which surround the center
- Approximately 27 miles Northwest of Chicago

AVAILABLE SUITE AREA—\$16/square foot NNN:

Approximately 35,877 square feet

NNN: Base rent plus prorata share of Real Estate Taxes, Insurance, and Common Area expenses, including but not limited to snow removal, lawn care, and parking lot maintenance. Tenant pays separately metered utilities for gas, electric, water, sewer, & trash removal.

CALL 330-729-1010 FOR MORE INFORMATION

www.coccadevelopment.com

EXHIBIT "B"
SITE PLAN

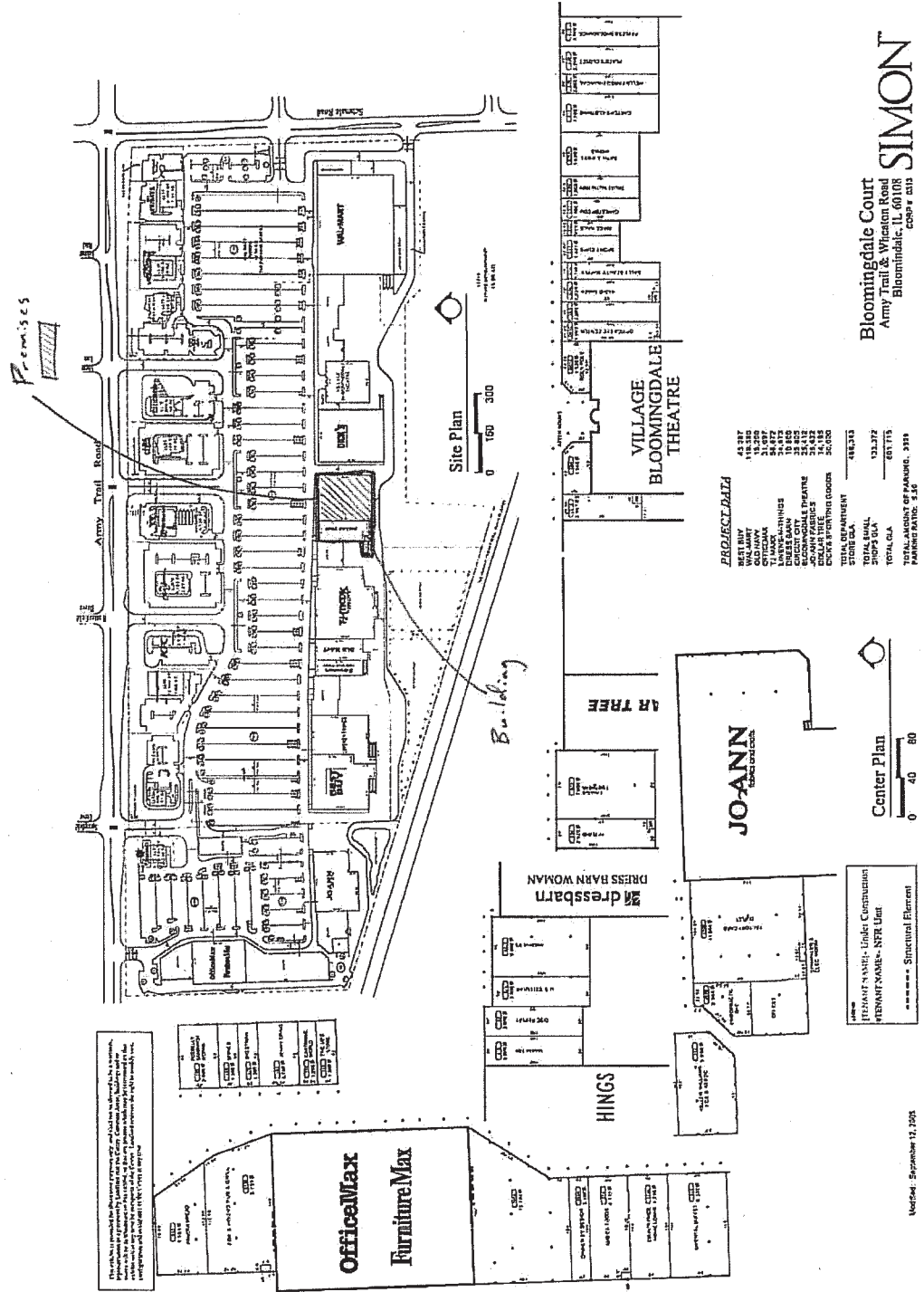

PROJECT DATA

WALMART	41,287
WALMART	418,385
OFFICE MAX	31,979
OTTIZ MAX	3,477
LANY'S HUTCHINS	34,477
DRESS BARN	33,885
ARMY TRAIL	26,412
AR TREE	22,412
JO-ANN	12,188
THEATRE	20,000
TOTAL	488,373

TOTAL BUILT	123,372
TOTAL GFA	851,175

TOTAL VOLUME OF PAVEMENT: 3314
PAVEMENT CONC. 2.26

Bloomingdale Court
Army Trail & Wisconsin Road
Bloomingdale, IL 60108
CDP # 0313

SIMON

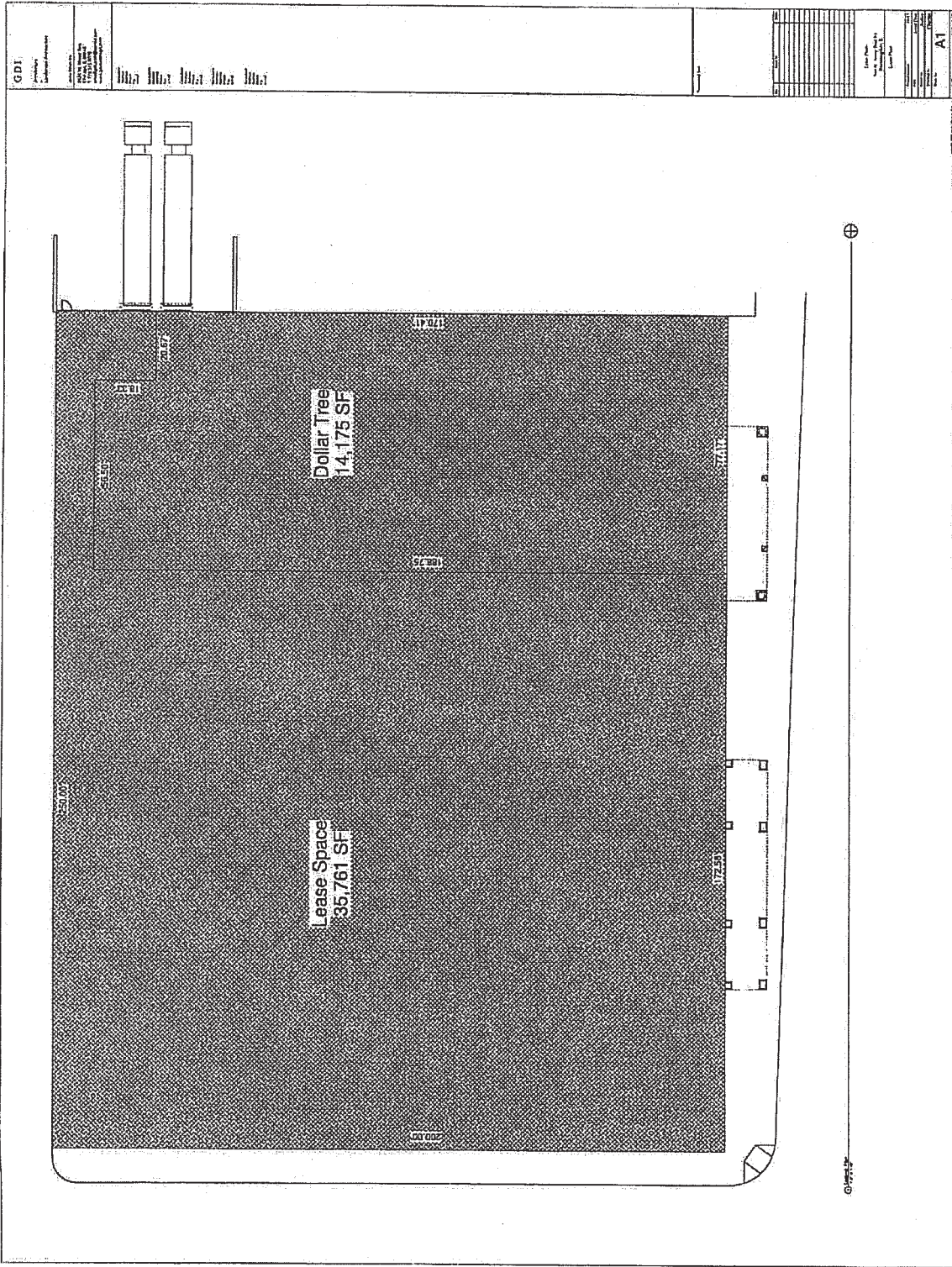

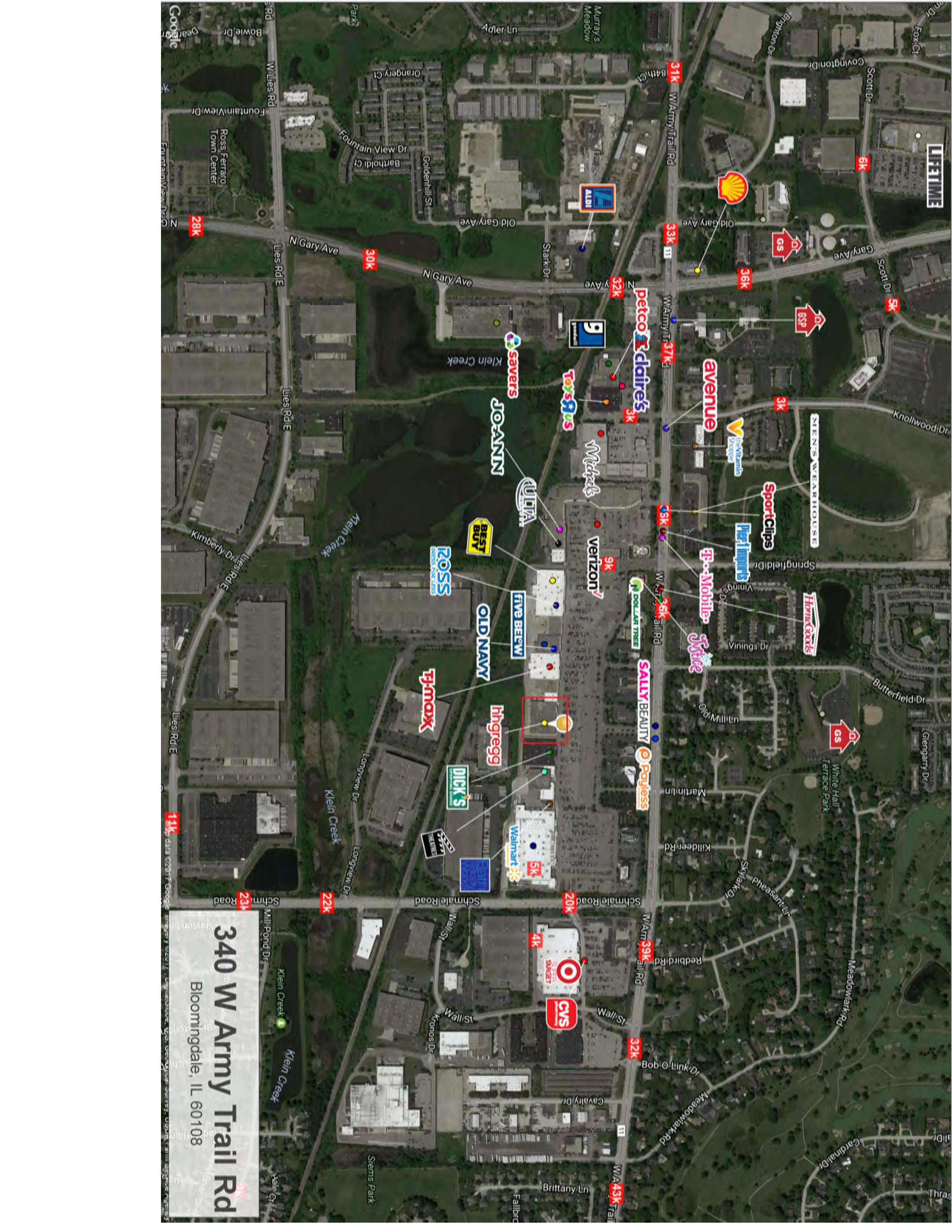

340 W Army Trail Rd
Bloomingdale, IL 60108

340 W Army Trail Rd
Bloomington, IL
 Current Year Estimated
 Average Household Income

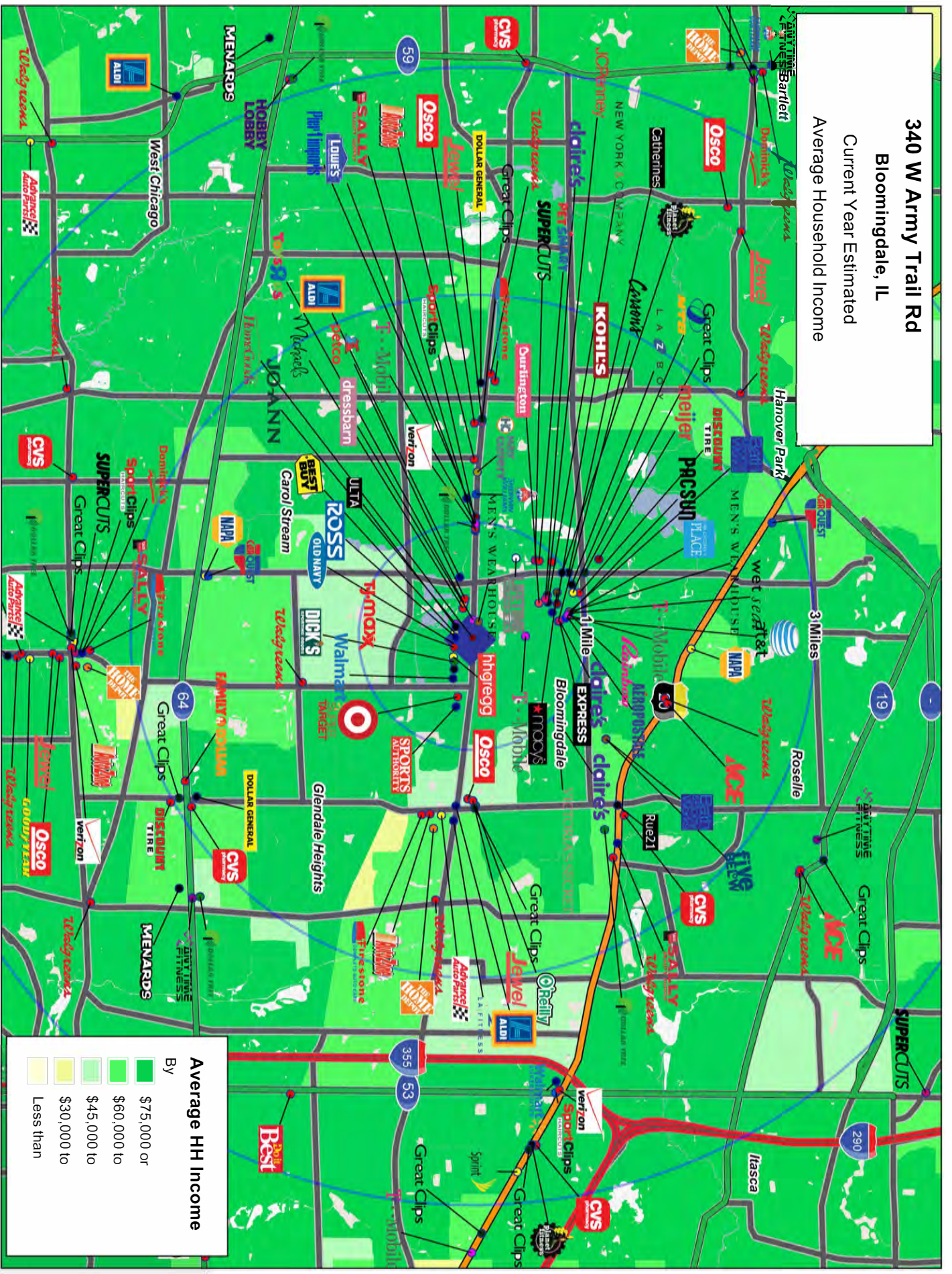

Average HH Income

By

- \$75,000 or more
- \$60,000 to \$75,000
- \$45,000 to \$60,000
- \$30,000 to \$45,000
- Less than \$30,000

This map was produced using data from private and government sources deemed to be reliable. The information herein is provided without representation or warranty.

340 WEST ARMY TRAIL ROAD BLOOMINGDALE, IL 60108

The site is located on West Army Trail Road in the Bloomingdale Court Shopping Center, approximately 25 miles Northwest of Chicago and 58 miles Northwest of Gary, Indiana.

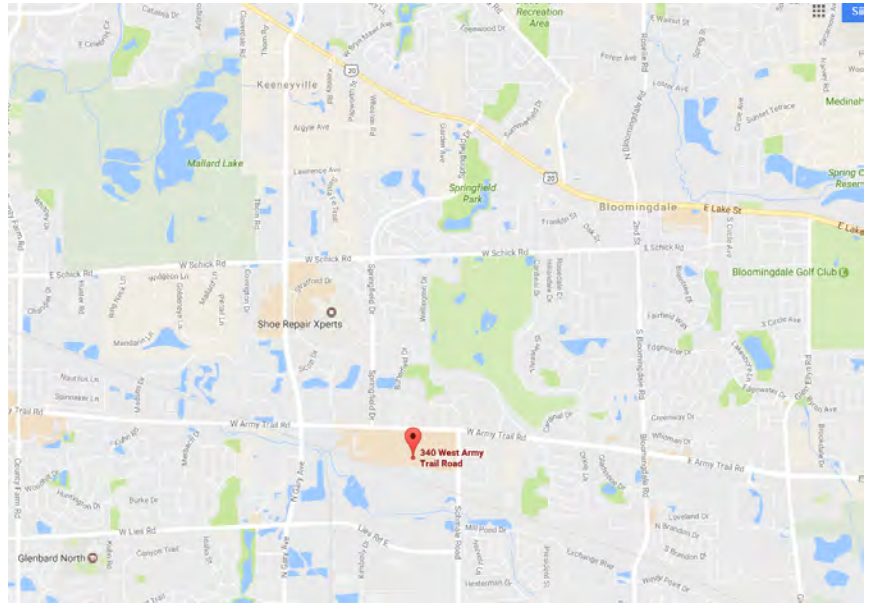

It is just under 17 miles Southeast of O'Hare International Airport and 27 miles Northwest of Chicago Midway International Airport.

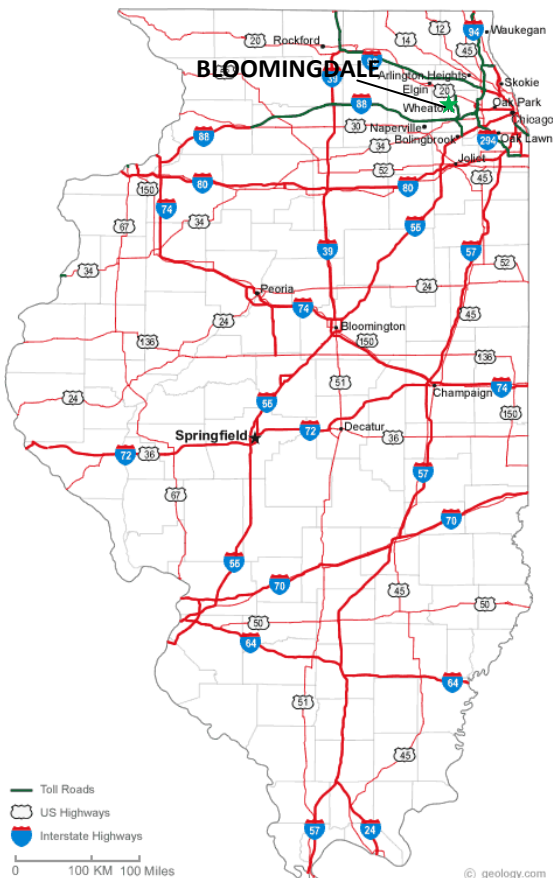

Conveniently located to State Route 20 and Interstates 290, 294, and 355, one can easily get to many larger cities to pull in more people.

COCCA DEVELOPMENT, LTD

340 WEST ARMY TRAIL ROAD BLOOMINGDALE, IL 60108

AT A GLANCE

- ◆ Originally Bloomingdale was a Cook County settlement but was annexed by DuPage County as a village in 1839.
- ◆ It was an important stop for stage coaches and westward travelers.
- ◆ The community was originally served by the Chicago-Galena Highway, which is now Lake Street.
- ◆ Stratford Square Mall at the intersection of Springfield Road & Schick Road is the largest of Bloomingdale's shopping centers.
- ◆ Since Bloomingdale is in close proximity to Chicago, it is a major shopping hub to the area.
- ◆ Over the past decade the State of Illinois has become a leading advocate for historic preservation, and Old Town Bloomingdale at the intersection of Lake Street & Bloomingdale Road is no exception. The area is a collection of small businesses & retail shops housed in restored buildings at the original site of the village's first settlement.

GRAPHIC PROFILE

2000-2010 Census, 2014 Estimates with 2019 Projections

Calculated using Proportional Block Groups

Lat/Lon: 41.9391/-88.1097

RGRAP3

340 W Army Trail Rd

Bloomington, IL

1 Mile

3 Miles

5 Miles

Population

Estimated Population (2014)	6,834	105,702	254,883
Projected Population (2019)	6,969	107,790	259,900
Census Population (2010)	6,805	105,246	253,293
Census Population (2000)	6,704	104,731	252,395
Projected Annual Growth (2014-2019)	135 0.4%	2,088 0.4%	5,017 0.4%
Historical Annual Growth (2010-2014)	29 0.4%	456 0.1%	1,590 0.1%
Historical Annual Growth (2000-2010)	100 0.1%	515 -	898 -
Estimated Population Density (2014)	2,177 <i>psm</i>	3,740 <i>psm</i>	3,247 <i>psm</i>
Trade Area Size	3.1 <i>sq mi</i>	28.3 <i>sq mi</i>	78.5 <i>sq mi</i>

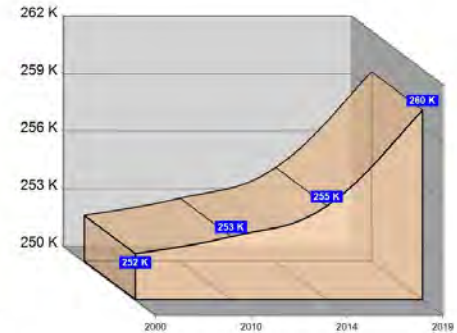
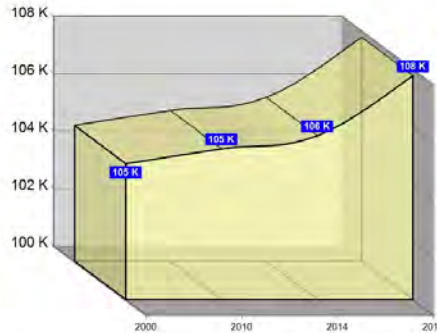
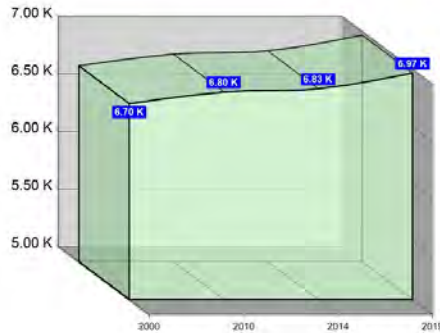

Race and Ethnicity (2014)

Not Hispanic or Latino Population	6,013 88.0%	87,108 82.4%	211,450 83.0%
White	4,237 70.5%	63,766 73.2%	165,025 78.0%
Black or African American	313 5.2%	4,705 5.4%	10,623 5.0%
American Indian or Alaska Native	19 0.3%	163 0.2%	324 0.2%
Asian	1,342 22.3%	16,734 19.2%	31,393 14.8%
Hawaiian or Pacific Islander	3 0.1%	23 -	64 -
Other Race	3 0.1%	60 0.1%	130 0.1%
Two or More Races	96 1.6%	1,657 1.9%	3,891 1.8%
Hispanic or Latino Population	821 12.0%	18,593 17.6%	43,433 17.0%
White	482 58.7%	9,542 51.3%	23,784 54.8%
Black or African American	10 1.3%	289 1.6%	664 1.5%
American Indian or Alaska Native	11 1.3%	234 1.3%	643 1.5%
Asian	19 2.3%	286 1.5%	569 1.3%
Hispanic Hawaiian or Pacific Islander	1 0.1%	11 0.1%	17 -
Other Race	245 29.9%	7,283 39.2%	15,520 35.7%
Two or More Races	53 6.5%	949 5.1%	2,236 5.1%

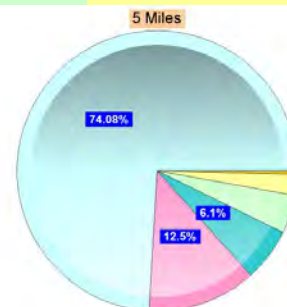
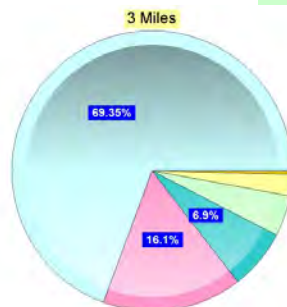

White Black or African American American Indian or Alaska Native Asian Hawaiian or Pacific Islander Other Race 2+ Races

This report was produced using data from private and government sources deemed to be reliable. The information herein is provided without representation or warranty.

GRAPHIC PROFILE

2000-2010 Census, 2014 Estimates with 2019 Projections

Calculated using Proportional Block Groups

Lat/Lon: 41.9391/-88.1097

RGRAP3

340 W Army Trail Rd Bloomington, IL

	1 Mile		3 Miles		5 Miles	
Age Distribution (2014)						
Age Under 5 Years	384	5.6%	6,219	5.9%	15,489	6.1%
Age 5 to 9 Years	366	5.4%	6,563	6.2%	16,255	6.4%
Age 10 to 14 Years	387	5.7%	6,940	6.6%	17,427	6.8%
Age 15 to 19 Years	407	6.0%	7,867	7.4%	19,105	7.5%
Age 20 to 24 Years	465	6.8%	7,218	6.8%	17,306	6.8%
Age 25 to 29 Years	601	8.8%	7,387	7.0%	16,341	6.4%
Age 30 to 34 Years	531	7.8%	7,491	7.1%	17,383	6.8%
Age 35 to 39 Years	452	6.6%	6,872	6.5%	16,540	6.5%
Age 40 to 44 Years	440	6.4%	6,989	6.6%	17,281	6.8%
Age 45 to 49 Years	507	7.4%	7,832	7.4%	18,876	7.4%
Age 50 to 54 Years	565	8.3%	8,339	7.9%	19,957	7.8%
Age 55 to 59 Years	543	8.0%	7,880	7.5%	18,602	7.3%
Age 60 to 64 Years	476	7.0%	6,320	6.0%	14,921	5.9%
Age 65 to 69 Years	286	4.2%	4,367	4.1%	10,824	4.2%
Age 70 to 74 Years	172	2.5%	2,800	2.6%	7,043	2.8%
Age 75 to 79 Years	114	1.7%	1,793	1.7%	4,788	1.9%
Age 80 to 84 Years	73	1.1%	1,229	1.2%	3,136	1.2%
Age 85 Years or Over	63	0.9%	1,595	1.5%	3,610	1.4%
Median Age	37.3		37.0		37.3	

	1 Mile		3 Miles		5 Miles	
Generation (2014)						
Generation 9/11 Millennials (Age Under 10 Years)	750	11.0%	12,783	12.1%	31,744	12.5%
Gen Y to Echo Boomers (Age 10 to 29 Years)	1,859	27.2%	29,411	27.8%	70,179	27.5%
Gen Xers (Age 30 to 49 Years)	1,931	28.3%	29,185	27.6%	70,080	27.5%
Baby Boomers (Age 50 to 69 Years)	1,871	27.4%	26,906	25.5%	64,303	25.2%
Silent Generation (Age 70 to 79 Years)	286	4.2%	4,593	4.3%	11,831	4.6%
G.I. Generation (Age 80 Years or Over)	136	2.0%	2,824	2.7%	6,746	2.6%

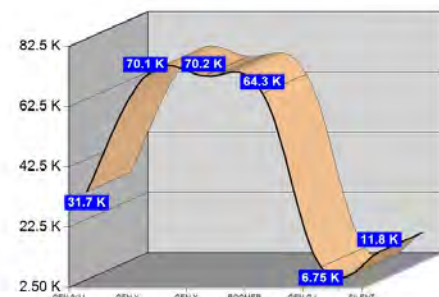
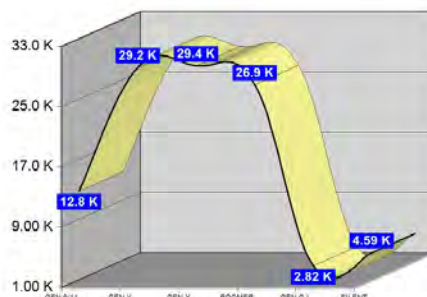
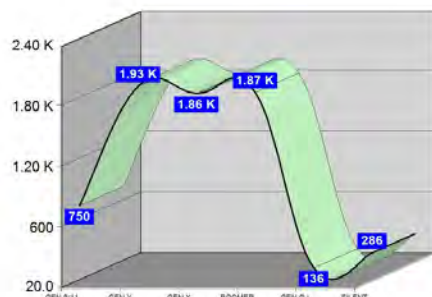

This report was produced using data from private and government sources deemed to be reliable. The information herein is provided without representation or warranty.

GRAPHIC PROFILE

2000-2010 Census, 2014 Estimates with 2019 Projections

Calculated using Proportional Block Groups

Lat/Lon: 41.9391/-88.1097

RGRAP3

340 W Army Trail Rd

Bloomington, IL

1 Mile

3 Miles

5 Miles

Household Type (2014)

	1 Mile	3 Miles	5 Miles
Total Households	2,688	37,067	89,369
Family Households	1,823 36.0%	27,652 36.8%	66,650 36.5%
Family Households with Children	855 46.9%	14,015 50.7%	34,034 51.1%
Family Households No Children	968 53.1%	13,637 49.3%	32,616 48.9%
Non-Family Households	865 36.0%	9,415 36.8%	22,719 36.5%
Non-Family Households with Children	7 0.8%	95 1.0%	201 0.9%
Non-Family Households No Children	859 99.2%	9,319 99.0%	22,519 99.1%

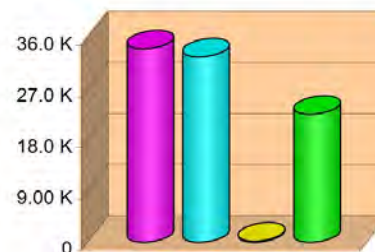
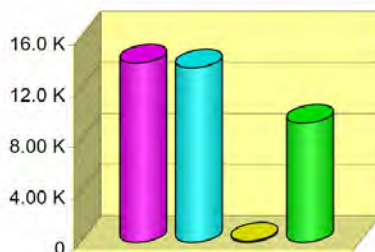
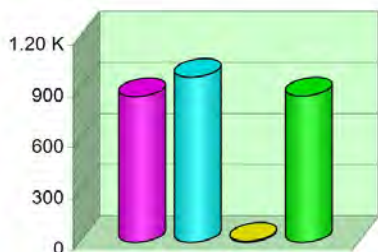

Education Attainment (2014)

	1 Mile	3 Miles	5 Miles
Elementary or Some High School	372 7.7%	7,315 10.4%	17,045 10.2%
High School Graduate	1,021 21.3%	17,438 24.9%	39,989 23.8%
Some College or Associate Degree	1,585 33.0%	21,665 30.9%	48,760 29.1%
Bachelor or Graduate Degree	1,819 37.9%	23,740 33.8%	62,038 37.0%

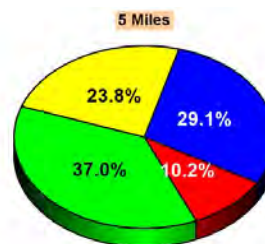
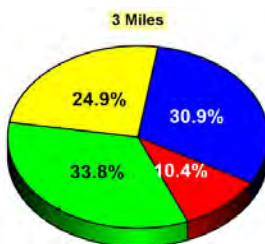
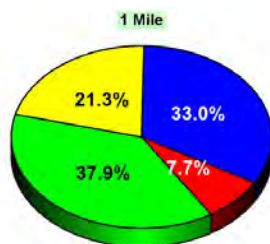

Household Income (2014)

	1 Mile	3 Miles	5 Miles
Estimated Average Household Income	\$100,432	\$82,213	\$85,613
Estimated Median Household Income	\$81,133	\$71,027	\$72,524
HH Income Under \$10,000	33 1.2%	1,008 2.7%	2,920 3.3%
HH Income \$10,000 to \$34,999	175 6.5%	5,373 14.5%	13,542 15.2%
HH Income \$35,000 to \$49,999	241 9.0%	4,515 12.2%	9,727 10.9%
HH Income \$50,000 to \$74,999	566 21.1%	7,106 19.2%	16,402 18.4%
HH Income \$75,000 to \$99,999	645 24.0%	7,055 19.0%	17,005 19.0%
HH Income \$100,000 to \$149,999	645 24.0%	7,055 19.0%	17,005 19.0%
HH Income \$150,000 or More	481 17.9%	5,677 15.3%	15,560 17.4%

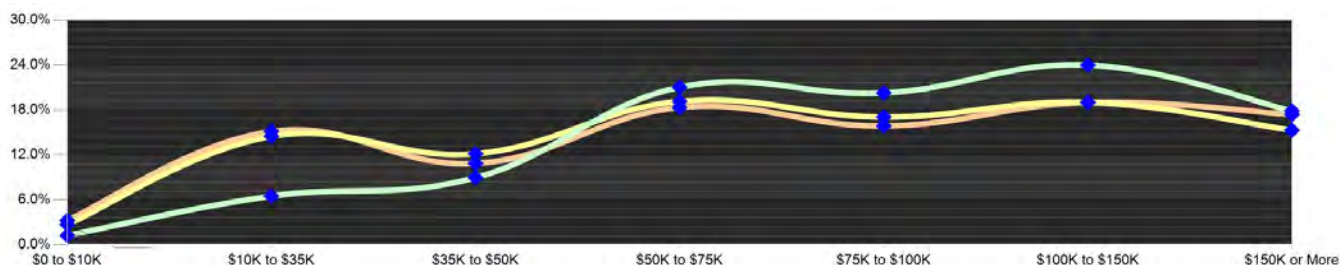

This report was produced using data from private and government sources deemed to be reliable. The information herein is provided without representation or warranty.

EXPANDED PROFILE

2000-2010 Census, 2014 Estimates with 2019 Projections

Calculated using Proportional Block Groups

Lat/Lon: 41.9391/-88.1097

RF5

340 W Army Trail Rd

Bloomington, IL

	1 Mile		3 Miles		5 Miles	
Population						
Estimated Population (2014)	6,834		105,702		254,883	
Projected Population (2019)	6,969		107,790		259,900	
Census Population (2010)	6,805		105,246		253,293	
Census Population (2000)	6,704		104,731		252,395	
Projected Annual Growth (2014 to 2019)	135	0.4%	2,088	0.4%	5,017	0.4%
Historical Annual Growth (2010 to 2014)	29	0.1%	456	0.1%	1,590	0.2%
Historical Annual Growth (2000 to 2010)	100	0.1%	515	-	898	-
Estimated Population Density (2014)	2,177	psm	3,740	psm	3,247	psm
Trade Area Size	3.14	sq mi	28.26	sq mi	78.49	sq mi
Households						
Estimated Households (2014)	2,688		37,067		89,369	
Projected Households (2019)	2,764		38,111		91,837	
Census Households (2010)	2,642		36,425		87,756	
Census Households (2000)	2,585		35,370		85,577	
Estimated Households with Children (2014)	861	32.0%	14,111	38.1%	34,235	38.3%
Estimated Average Household Size (2014)	2.53		2.83		2.82	
Average Household Income						
Estimated Average Household Income (2014)	\$102,097		\$88,509		\$93,402	
Projected Average Household Income (2019)	\$110,707		\$96,208		\$101,685	
Estimated Average Family Income (2014)	\$112,438		\$96,852		\$103,874	
Median Household Income						
Estimated Median Household Income (2014)	\$91,024		\$79,513		\$81,627	
Projected Median Household Income (2019)	\$97,906		\$85,830		\$88,469	
Estimated Median Family Income (2014)	\$100,430		\$89,068		\$93,552	
Per Capita Income						
Estimated Per Capita Income (2014)	\$40,217		\$31,084		\$32,831	
Projected Per Capita Income (2019)	\$43,965		\$34,066		\$36,018	
Estimated Per Capita income 5 Year Growth	\$3,748	9.3%	\$2,982	9.6%	\$3,187	9.7%
Estimated Average Household Net Worth (2014)	\$812,090		\$711,484		\$733,229	
Daytime Demos (2014)						
Total Businesses	502		3,906		10,292	
Total Employees	10,615		56,869		131,070	
Company Headquarter Businesses	7	1.3%	34	0.9%	72	0.7%
Company Headquarter Employees	607	5.7%	4,026	7.1%	8,638	6.6%
Employee Population per Business	21.1		14.6		12.7	
Residential Population per Business	13.6		27.1		24.8	

This report was produced using data from private and government sources deemed to be reliable. The information herein is provided without representation or warranty.

EXPANDED PROFILE

2000-2010 Census, 2014 Estimates with 2019 Projections

Calculated using Proportional Block Groups

Lat/Lon: 41.9391/-88.1097

RF5

340 W Army Trail Rd

Bloomington, IL

Race & Ethnicity

	1 Mile		3 Miles		5 Miles	
White (2014)	4,718	69.0%	73,307	69.4%	188,809	74.1%
Black or African American (2014)	324	4.7%	4,994	4.7%	11,287	4.4%
American Indian or Alaska Native (2014)	30	0.4%	397	0.4%	968	0.4%
Asian (2014)	1,361	19.9%	17,021	16.1%	31,962	12.5%
Hawaiian or Pacific Islander (2014)	4	0.1%	34	-	81	-
Other Race (2014)	249	3.6%	7,342	6.9%	15,649	6.1%
Two or More Races (2014)	149	2.2%	2,607	2.5%	6,127	2.4%
Not Hispanic or Latino Population (2014)	6,013	88.0%	87,108	82.4%	211,450	83.0%
Hispanic or Latino Population (2014)	821	12.0%	18,593	17.6%	43,433	17.0%
Not Hispanic or Latino Population (2019)	6,087	87.3%	87,828	81.5%	213,427	82.1%
Hispanic or Latino Population (2019)	882	12.7%	19,962	18.5%	46,473	17.9%
Not Hispanic or Latino Population (2010)	6,032	88.6%	87,747	83.4%	212,368	83.8%
Hispanic or Latino Population (2010)	773	11.4%	17,499	16.6%	40,925	16.2%
Not Hispanic or Latino Population (2000)	6,267	93.5%	94,163	89.9%	225,826	89.5%
Hispanic or Latino Population (2000)	437	6.5%	10,568	10.1%	26,569	10.5%
Projected Hispanic Annual Growth (2014 to 2019)	61	1.5%	1,368	1.5%	3,039	1.4%
Historic Hispanic Annual Growth (2000 to 2014)	384	6.3%	8,026	5.4%	16,865	4.5%

Age Distribution (2014)

Age Under 5	384	5.6%	6,219	5.9%	15,489	6.1%
Age 5 to 9 Years	366	5.4%	6,563	6.2%	16,255	6.4%
Age 10 to 14 Years	387	5.7%	6,940	6.6%	17,427	6.8%
Age 15 to 19 Years	407	6.0%	7,867	7.4%	19,105	7.5%
Age 20 to 24 Years	465	6.8%	7,218	6.8%	17,306	6.8%
Age 25 to 29 Years	601	8.8%	7,387	7.0%	16,341	6.4%
Age 30 to 34 Years	531	7.8%	7,491	7.1%	17,383	6.8%
Age 35 to 39 Years	452	6.6%	6,872	6.5%	16,540	6.5%
Age 40 to 44 Years	440	6.4%	6,989	6.6%	17,281	6.8%
Age 45 to 49 Years	507	7.4%	7,832	7.4%	18,876	7.4%
Age 50 to 54 Years	565	8.3%	8,339	7.9%	19,957	7.8%
Age 55 to 59 Years	543	8.0%	7,880	7.5%	18,602	7.3%
Age 60 to 64 Years	476	7.0%	6,320	6.0%	14,921	5.9%
Age 65 to 74 Years	458	6.7%	7,167	6.8%	17,867	7.0%
Age 75 to 84 Years	187	2.7%	3,022	2.9%	7,924	3.1%
Age 85 Years or Over	63	0.9%	1,595	1.5%	3,610	1.4%
Median Age	37.3		37.0		37.3	

Gender Age Distribution (2014)

Female Population	3,471	50.8%	53,359	50.5%	128,941	50.6%
Age 0 to 19 Years	757	21.8%	13,325	25.0%	33,259	25.8%
Age 20 to 64 Years	2,336	67.3%	33,337	62.5%	79,068	61.3%
Age 65 Years or Over	377	10.9%	6,697	12.6%	16,614	12.9%
Female Median Age	38.3		38.4		38.5	
Male Population	3,363	49.2%	52,343	49.5%	125,942	49.4%
Age 0 to 19 Years	787	23.4%	14,264	27.3%	35,016	27.8%
Age 20 to 64 Years	2,245	66.8%	32,992	63.0%	78,139	62.0%
Age 65 Years or Over	331	9.8%	5,087	9.7%	12,787	10.2%
Male Median Age	36.5		35.6		36.0	

This report was produced using data from private and government sources deemed to be reliable. The information herein is provided without representation or warranty.

EXPANDED PROFILE

2000-2010 Census, 2014 Estimates with 2019 Projections

Calculated using Proportional Block Groups

Lat/Lon: 41.9391/-88.1097

RF5

340 W Army Trail Rd

Bloomington, IL

Household Income Distribution (2014)

	1 Mile		3 Miles		5 Miles	
HH Income \$200,000 or More	220	8.2%	2,516	6.8%	7,196	8.1%
HH Income \$150,000 to \$199,999	261	9.7%	3,161	8.5%	8,364	9.4%
HH Income \$100,000 to \$149,999	645	24.0%	7,055	19.0%	17,005	19.0%
HH Income \$75,000 to \$99,999	546	20.3%	6,332	17.1%	14,213	15.9%
HH Income \$50,000 to \$74,999	566	21.1%	7,106	19.2%	16,402	18.4%
HH Income \$35,000 to \$49,999	241	9.0%	4,515	12.2%	9,727	10.9%
HH Income \$25,000 to \$34,999	122	4.5%	2,765	7.5%	6,400	7.2%
HH Income \$15,000 to \$24,999	42	1.6%	2,113	5.7%	5,729	6.4%
HH Income Under \$15,000	44	1.7%	1,503	4.1%	4,333	4.8%
HH Income \$35,000 or More	2,480	92.2%	30,685	82.8%	72,907	81.6%
HH Income \$75,000 or More	1,672	62.2%	19,064	51.4%	46,778	52.3%

Housing (2014)

	1 Mile		3 Miles		5 Miles	
Total Housing Units	2,774		38,127		92,209	
Housing Units Occupied	2,688	96.9%	37,067	97.2%	89,369	96.9%
Housing Units Owner-Occupied	1,915	71.2%	28,528	77.0%	69,153	77.4%
Housing Units, Renter-Occupied	774	28.8%	8,539	23.0%	20,216	22.6%
Housing Units, Vacant	85	3.1%	1,060	2.8%	2,839	3.1%

Marital Status (2014)

	1 Mile		3 Miles		5 Miles	
Never Married	1,825	32.0%	26,314	30.6%	63,454	30.8%
Currently Married	2,908	51.0%	45,638	53.1%	108,239	52.6%
Separated	183	3.2%	3,077	3.6%	7,391	3.6%
Widowed	203	3.6%	3,888	4.5%	9,230	4.5%
Divorced	577	10.1%	7,062	8.2%	17,398	8.5%

Household Type (2014)

	1 Mile		3 Miles		5 Miles	
Population Family	5,583	81.7%	91,634	86.7%	219,193	86.0%
Population Non-Family	1,218	17.8%	13,306	12.6%	32,427	12.7%
Population Group Quarters	32	0.5%	761	0.7%	3,263	1.3%
Family Households	1,823	67.8%	27,652	74.6%	66,650	74.6%
Non-Family Households	865	32.2%	9,415	25.4%	22,719	25.4%
Married Couple with Children	631	21.7%	10,816	23.7%	26,493	24.5%
Average Family Household Size	3.1		3.3		3.3	

Household Size (2014)

	1 Mile		3 Miles		5 Miles	
1 Person Households	675	25.1%	7,485	20.2%	18,314	20.5%
2 Person Households	898	33.4%	10,932	29.5%	26,782	30.0%
3 Person Households	468	17.4%	6,805	18.4%	15,980	17.9%
4 Person Households	388	14.4%	6,460	17.4%	15,567	17.4%
5 Person Households	164	6.1%	3,224	8.7%	7,700	8.6%
6 or More Person Households	95	3.5%	2,161	5.8%	5,028	5.6%

Household Vehicles (2014)

	1 Mile		3 Miles		5 Miles	
Households with 0 Vehicles Available	61	2.3%	1,081	2.9%	3,161	3.5%
Households with 1 Vehicles Available	891	33.1%	10,795	29.1%	26,587	29.7%
Households with 2 or More Vehicles Available	1,736	64.6%	25,190	68.0%	59,622	66.7%
Total Vehicles Available	5,220		74,195		175,322	
Average Vehicles Per Household	1.9		2.0		2.0	

This report was produced using data from private and government sources deemed to be reliable. The information herein is provided without representation or warranty.

EXPANDED PROFILE

2000-2010 Census, 2014 Estimates with 2019 Projections

Calculated using Proportional Block Groups

Lat/Lon: 41.9391/-88.1097

RF5

340 W Army Trail Rd

Bloomington, IL

Labor Force (2014)

	1 Mile		3 Miles		5 Miles	
Estimated Labor Population Age 16 Years or Over	5,583		83,604		198,622	
Estimated Civilian Employed	3,981	71.3%	57,753	69.1%	135,247	68.1%
Estimated Civilian Unemployed	269	4.8%	4,651	5.6%	10,794	5.4%
Estimated in Armed Forces	7	0.1%	11	-	30	-
Estimated Not in Labor Force	1,326	23.8%	21,189	25.3%	52,552	26.5%
Unemployment Rate	4.8%		5.6%		5.4%	

Occupation (2010)

	1 Mile		3 Miles		5 Miles	
Occupation: Population Age 16 Years or Over	3,884		54,916		128,983	
Management, Business, Financial Operations	878	22.6%	8,616	15.7%	22,047	17.1%
Professional, Related	747	19.2%	10,747	19.6%	26,503	20.5%
Service	405	10.4%	7,943	14.5%	18,570	14.4%
Sales, Office	1,397	36.0%	16,740	30.5%	37,398	29.0%
Farming, Fishing, Forestry	-	-	16	-	68	0.1%
Construct, Extraction, Maintenance	123	3.2%	4,128	7.5%	9,189	7.1%
Production, Transport Material Moving	336	8.6%	6,727	12.2%	15,208	11.8%
White Collar Workers	3,021	77.8%	36,103	65.7%	85,948	66.6%
Blue Collar Workers	863	22.2%	18,813	34.3%	43,035	33.4%

Consumer Expenditure (2014)

	1 Mile		3 Miles		5 Miles	
Total Household Expenditure	\$194 M		\$2.40 B		\$6.00 B	
Total Non-Retail Expenditure	\$112 M	58.0%	\$1.39 B	57.9%	\$3.47 B	57.9%
Total Retail Expenditure	\$81.3 M	42.0%	\$1.01 B	42.1%	\$2.53 B	42.1%
Apparel	\$9.36 M	4.8%	\$116 M	4.8%	\$291 M	4.8%
Contributions	\$8.04 M	4.2%	\$97.5 M	4.1%	\$250 M	4.2%
Education	\$5.27 M	2.7%	\$63.1 M	2.6%	\$162 M	2.7%
Entertainment	\$11.0 M	5.7%	\$136 M	5.7%	\$340 M	5.7%
Food and Beverages	\$28.6 M	14.8%	\$358 M	14.9%	\$892 M	14.9%
Furnishings and Equipment	\$8.96 M	4.6%	\$109 M	4.5%	\$273 M	4.6%
Gifts	\$5.62 M	2.9%	\$67.9 M	2.8%	\$173 M	2.9%
Health Care	\$11.0 M	5.7%	\$139 M	5.8%	\$344 M	5.7%
Household Operations	\$7.54 M	3.9%	\$91.8 M	3.8%	\$233 M	3.9%
Miscellaneous Expenses	\$3.11 M	1.6%	\$38.8 M	1.6%	\$96.6 M	1.6%
Personal Care	\$2.78 M	1.4%	\$34.4 M	1.4%	\$86.0 M	1.4%
Personal Insurance	\$2.16 M	1.1%	\$26.4 M	1.1%	\$67.0 M	1.1%
Reading	\$641 K	0.3%	\$7.86 M	0.3%	\$19.7 M	0.3%
Shelter	\$37.7 M	19.5%	\$467 M	19.4%	\$1.17 B	19.5%
Tobacco	\$1.05 M	0.5%	\$13.8 M	0.6%	\$33.8 M	0.6%
Transportation	\$38.3 M	19.8%	\$475 M	19.8%	\$1.18 B	19.6%
Utilities	\$12.6 M	6.5%	\$159 M	6.6%	\$395 M	6.6%

Educational Attainment (2014)

	1 Mile		3 Miles		5 Miles	
Adult Population Age 25 Years or Over	4,797		70,158		167,832	
Elementary (Grade Level 0 to 8)	154	3.2%	3,199	4.6%	8,293	4.9%
Some High School (Grade Level 9 to 11)	218	4.5%	4,116	5.9%	8,753	5.2%
High School Graduate	1,021	21.3%	17,438	24.9%	39,989	23.8%
Some College	1,277	26.6%	16,801	23.9%	37,008	22.1%
Associate Degree Only	308	6.4%	4,864	6.9%	11,752	7.0%
Bachelor Degree Only	1,259	26.2%	17,100	24.4%	42,306	25.2%
Graduate Degree	560	11.7%	6,640	9.5%	19,732	11.8%

This report was produced using data from private and government sources deemed to be reliable. The information herein is provided without representation or warranty.

EXPANDED PROFILE

2000-2010 Census, 2014 Estimates with 2019 Projections

Calculated using Proportional Block Groups

Lat/Lon: 41.9391/-88.1097

RF5

340 W Army Trail Rd

Bloomington, IL

Units In Structure (2010)

	1 Mile		3 Miles		5 Miles	
1 Detached Unit	1,136	43.0%	20,596	56.5%	51,651	58.9%
1 Attached Unit	696	26.3%	7,874	21.6%	15,333	17.5%
2 to 4 Units	135	5.1%	1,408	3.9%	4,172	4.8%
5 to 9 Units	216	8.2%	2,119	5.8%	4,849	5.5%
10 to 19 Units	352	13.3%	2,285	6.3%	4,528	5.2%
20 to 49 Units	50	1.9%	1,038	2.8%	3,467	4.0%
50 or More Units	50	1.9%	1,045	2.9%	3,467	4.0%
Mobile Home or Trailer	7	0.3%	60	0.2%	288	0.3%
Other Structure	-	-	1	-	1	-

Homes Built By Year (2010)

Homes Built 2005 or later	131	4.9%	1,097	3.0%	2,882	3.3%
Homes Built 2000 to 2004	115	4.4%	1,616	4.4%	4,354	5.0%
Homes Built 1990 to 1999	578	21.9%	6,078	16.7%	14,023	16.0%
Homes Built 1980 to 1989	810	30.7%	7,498	20.6%	14,826	16.9%
Homes Built 1970 to 1979	462	17.5%	9,723	26.7%	21,896	25.0%
Homes Built 1960 to 1969	157	5.9%	3,798	10.4%	10,481	11.9%
Homes Built 1950 to 1959	127	4.8%	2,779	7.6%	8,374	9.5%
Homes Built Before 1949	262	9.9%	3,836	10.5%	10,921	12.4%

Home Values (2010)

Home Values \$1,000,000 or More	22	1.2%	140	0.5%	659	1.0%
Home Values \$500,000 to \$999,999	180	9.6%	1,454	5.2%	5,143	7.6%
Home Values \$400,000 to \$499,999	127	6.8%	1,667	6.0%	5,189	7.7%
Home Values \$300,000 to \$399,999	401	21.4%	5,410	19.4%	13,790	20.4%
Home Values \$200,000 to \$299,999	541	28.9%	10,653	38.1%	22,814	33.7%
Home Values \$150,000 to \$199,999	332	17.7%	4,903	17.5%	10,179	15.0%
Home Values \$100,000 to \$149,999	139	7.4%	1,870	6.7%	5,057	7.5%
Home Values \$70,000 to \$99,999	55	3.0%	850	3.0%	2,082	3.1%
Home Values \$50,000 to \$69,999	24	1.3%	367	1.3%	951	1.4%
Home Values \$25,000 to \$49,999	16	0.9%	274	1.0%	878	1.3%
Home Values Under \$25,000	38	2.0%	365	1.3%	940	1.4%
Owner-Occupied Median Home Value	\$269,150		\$255,537		\$270,831	
Renter-Occupied Median Rent	\$1,199		\$987		\$930	

Transportation To Work (2010)

Drive to Work Alone	3,123	83.6%	44,241	83.3%	101,121	80.6%
Drive to Work in Carpool	271	7.2%	4,352	8.2%	9,929	7.9%
Travel to Work by Public Transportation	145	3.9%	1,572	3.0%	5,628	4.5%
Drive to Work on Motorcycle	3	0.1%	74	0.1%	138	0.1%
Walk or Bicycle to Work	17	0.4%	746	1.4%	2,635	2.1%
Other Means	12	0.3%	258	0.5%	752	0.6%
Work at Home	168	4.5%	1,893	3.6%	5,313	4.2%

Travel Time (2010)

Travel to Work in 14 Minutes or Less	632	17.7%	10,727	20.9%	25,595	21.3%
Travel to Work in 15 to 29 Minutes	1,189	33.3%	17,364	33.9%	40,609	33.8%
Travel to Work in 30 to 59 Minutes	1,411	39.5%	17,984	35.1%	40,991	34.1%
Travel to Work in 60 Minutes or More	337	9.4%	5,168	10.1%	13,008	10.8%
Average Minutes Travel to Work	27.4		25.9		25.7	

This report was produced using data from private and government sources deemed to be reliable. The information herein is provided without representation or warranty.